

16-00-072-000
 19158
 16-4
 19158

1045.44'
 DUE NORTH
 6.000 AC. SPLIT
 DUE SOUTH
 1045.44'
 DUE WEST
 250.00'
 IP SET

MICHAEL SAUTER
 D.R. VOL. 304 P. 479
 34.96 AC. ORIG.
 28.96 AC. REM.

NORTH
 SCALE 1" = 200'

#19158

APPROVED LORAIN CO. MAP DEPT.	
DATE	10-3-90
PAGE	16-H
BY	CAROLYN FRANCLIS
VOID AFTER #	19158

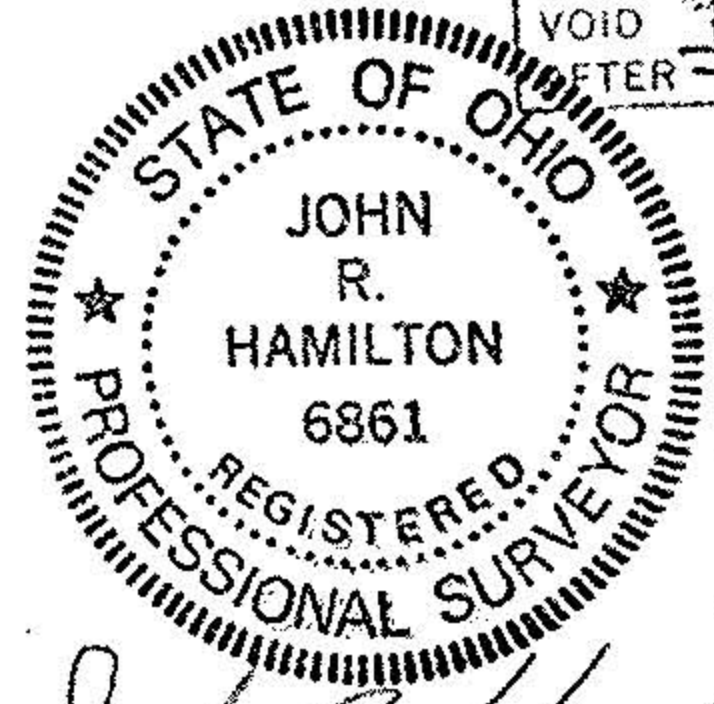

John R. Hamilton

MAP OF SURVEY FOR MICHAEL SAUTER
 GRAFTON TWP. - D.L. #72
 SEPT. 1990
 JOHN R. HAMILTON - REG. SURV. #6861