

SCALE: 1" = 100'

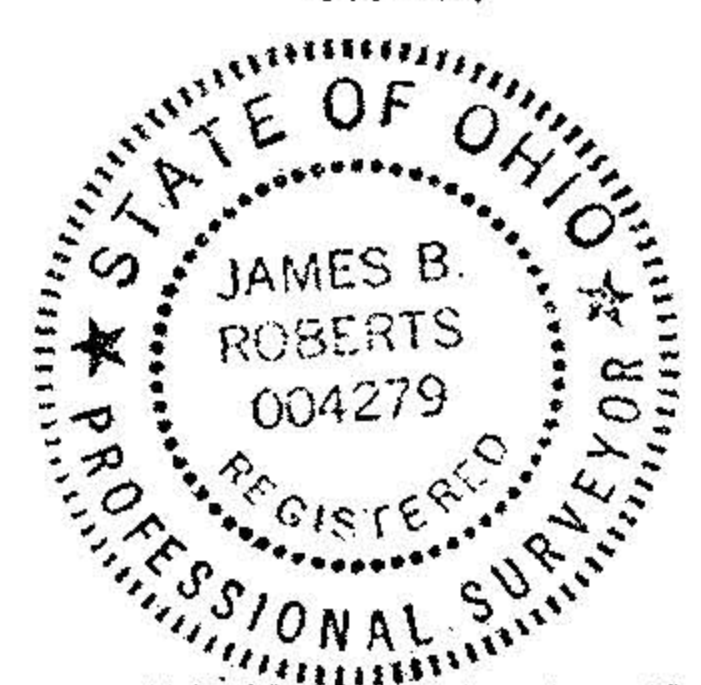

MAP OF PROPOSED PARCEL SPLIT
PREPARED FOR ARTHUR WESEMAYER
PART OF ORIGINAL GRAFTON TWP. LOT 52
TOWNSHIP OF GRAFTON, LORAIN COUNTY, OHIO
 REF: SPLIT FROM PP # 16-00-052-000-014

K.E. MCCARTNEY & ASSOCIATES
 ENGINEERS - SURVEYORS
 ELYRIA, OHIO
 JUNE, 1992 #924031