

PLAT OF SURVEY

MADE FOR

RALPH A., JR. & PAMELA A. PENCE

KNOWN AS BEING A PART OF ORIGINAL
LOT NO 52 & ORIGINAL LOT NO 53 OF
LAGRANGE TOWNSHIP, LDRAIN COUNTY, OHIO

1. PIN MONUMENT FOUND & USED
AT SOUTH PROPERTY LINE OF
LAND DESCRIBED IN DEED
RECORDED IN VOL. 700, PG. 706

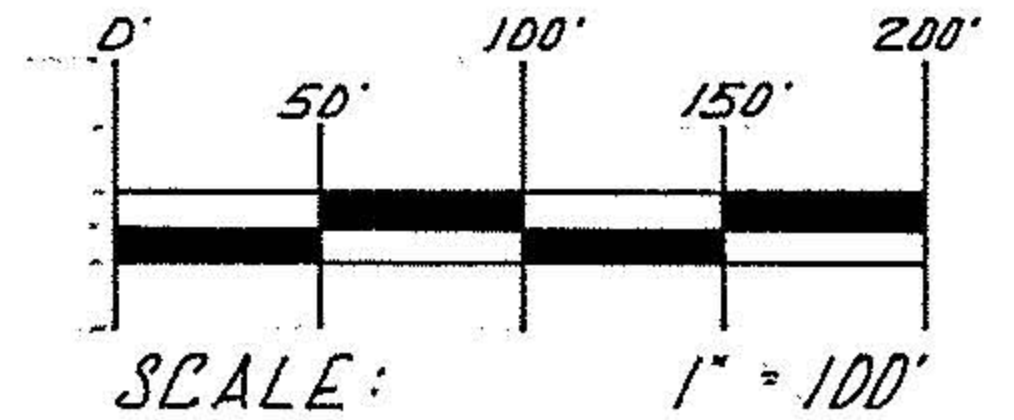
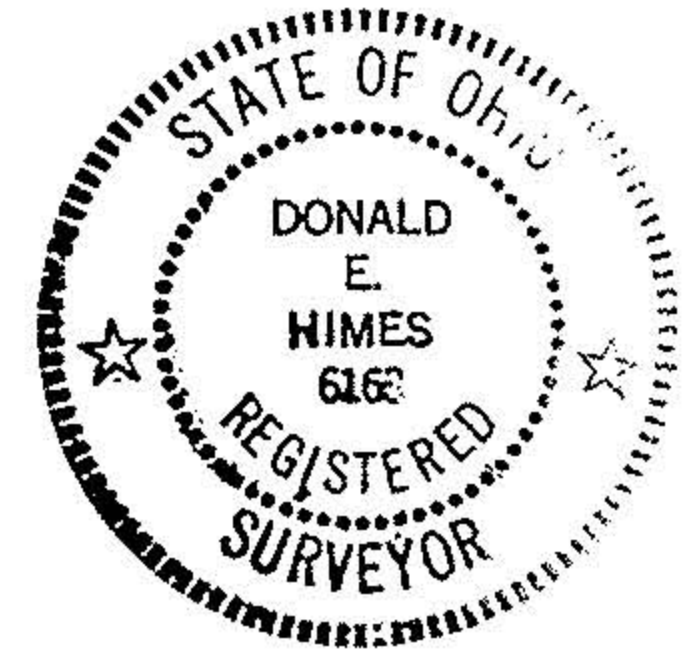

I DECLARE THIS PLAT TO BE A TRUE REPRESENTATION OF AN ACTUAL FIELD SURVEY MADE BY ME IN JULY, 1996, AND CORRECT TO THE BEST OF MY PROFESSIONAL KNOWLEDGE AND BELIEF. DISTANCES ARE GIVEN IN FEET AND DECIMALS. NORTH DATUM IS THE BEARING OF RECORD FOR THE CENTERLINE OF INDIAN HOLLOW ROAD. PROPERTY CORNERS WERE FOUND OR SET AS INDICATED.

- INDICATES IRON PIN SET (5/8" φ)
- INDICATES 1" φ IRON PIPE FOUND

ZWICK ASSOCIATES, INC.
ENGINEERS - SURVEYORS
8750 STEARNS ROAD, OLMSTED TOWNSHIP, OHIO 44138-1743
TELEPHONE: 216-235-1944 FAX: 216-235-0604

Donald E. Himes 7/24/96
REVISED TO 250' REAR WIDTH
Donald E. Himes 8/20/96

