

WEST STREET 40'

FACTORY STREET 40'

PROSPECT STREET 40'

SCALE: 1" = 40'

SURVEY MAP

SUBLOTS NOS 3, 4, & 5 - MERRIAM'S ADDITION

VILLAGE OF LAGRANGE COUNTY OF LORAIN STATE OF OHIO

PREPARED BY
KS ASSOCIATES INC.
 ENGINEERS SURVEYORS

David L. Elwell
 DAVID L. ELWELL - P.S. NO 6333

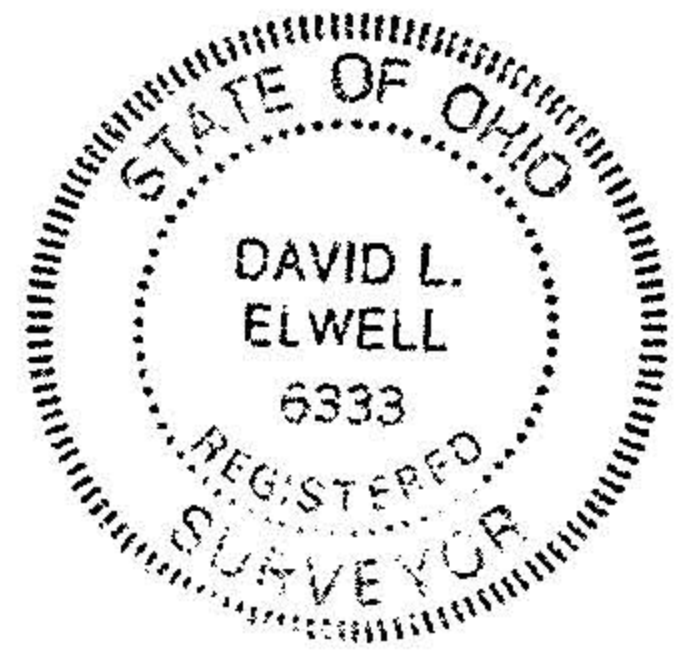

#19349

APPROVED	
LORAIN CO. MAP DEPT.	
DATE	5-7-91
PAGE	1500045-B
BY CAROLYN FRANCIS	
VOID AFTER	# 19349

4-11-91
 91-131