

STATE OF OHIO, COUNTY OF LORAIN, VILLAGE OF LAGRANGE, AND KNOWN AS BEING PART OF SUBLOT NOS. 32 AND 33 OF THE ORIGINAL LAGRANGE VILLAGE PLAT VOLUME 1 OF MAPS, PAGE 4 OF LORAIN COUNTY RECORDS, ALSO BEING PART OF ORIGINAL TOWNSHIP LOT NO 45.

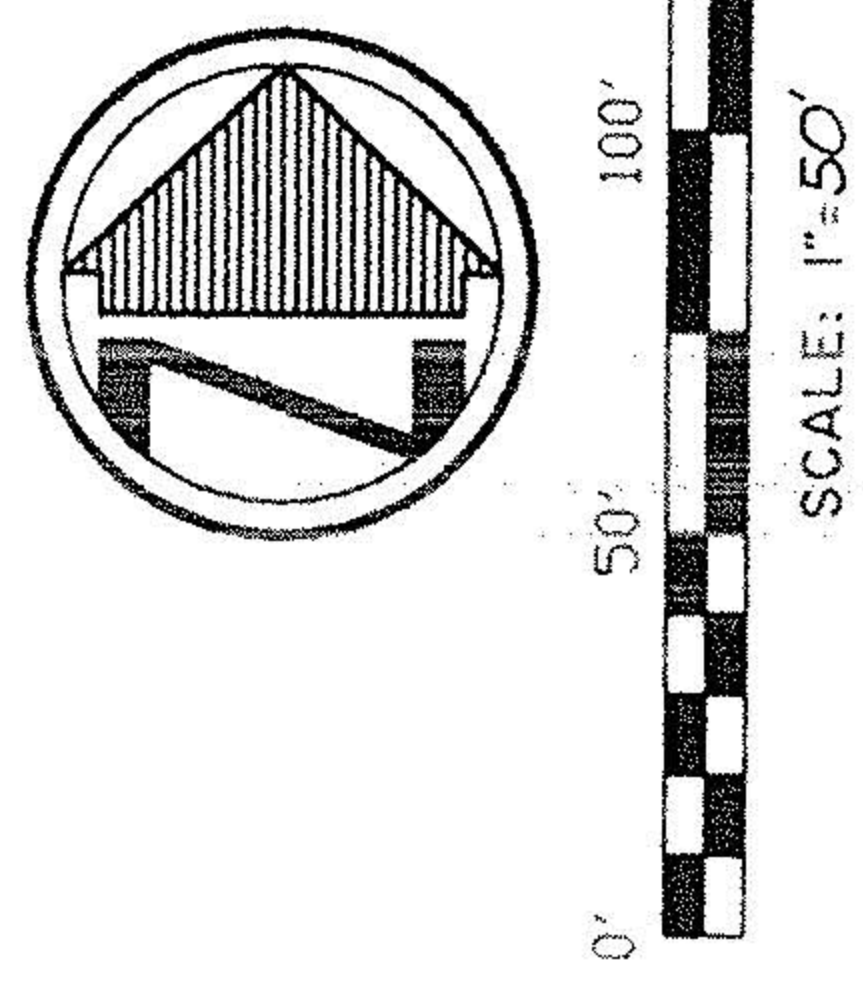

ROBERT D. ALDRICH  
VOL. 48 PG. 294  
P.P.N. 15-00-045-103-009

CHARLES L. & SHARON M. LYNCH  
INSTR. 970484140  
P.P.N. 15-00-045-103-022

PARCEL 'B'  
317587.4356 SQ. FT.  
7.2908 ACRES

SMITH RADER PARTNERSHIP  
VOL. 881 PG. 421  
P.P.N. 15-00-045-101-063

10.00' S1°00'00"E  
REC. & USED  
T.P.O.B. FOR  
PARCEL 'B'

97.60' W  
N 1°00'00"E  
CALC. & USED

32  
CHARLES L. & SHARON M. LYNCH  
INSTR. 970484140  
P.P.N. 15-00-045-105-035

PARCEL 'A'  
26504.9999 SQ. FT.  
0.6085 ACRES

271.59' REC. & USED  
S 88°25'28" W  
EUGENE HOPKINS  
VOL. 1127 PG. 527  
P.P.N. 15-00-045-105-034

S 89°37'18" W 313.50'  
TRUSTEES OF METHODIST EPISCOPAL  
CHURCH OF LAGRANGE  
VOL. 746 PG. 646  
P.P.N. 15-00-045-105-014

S/L 44  
GEORGIA P. SCOTT  
VOL. 19 PG. 812  
P.P.N. 15-00-045-101-033

S/L 43  
WALTER & BEULAH STEWART  
VOL. 1280 PG. 131  
P.P.N. 15-00-045-103-011

S/L 42  
DAVID G. CARMEL  
VOL. 1214 PG. 147  
P.P.N. 15-00-045-103-012

S/L 41  
STEVEN E. SOBOTKA  
VOL. 116 PG. 303  
P.P.N. 15-00-045-103-014 & 013

S/L 40  
RYMOND F. WELLS JR.  
VOL. 1225 PG. 873  
P.P.N. 15-00-045-103-020

S/L 39  
RICHARD M. GALLAGHER  
INSTR. 980554138  
P.P.N. 15-00-045-103-017

S/L 38  
FLORENCE BEHNER  
VOL. 917 PG. 480  
P.P.N. 15-00-045-103-018

S/L 37  
RUTH F. SPICER  
VOL. 104 PG. 170  
P.P.N. 15-00-045-103-019

S/L 36  
ROGER M. & SHARON M. POSEY  
VOL. 1342 PG. 448  
P.P.N. 15-00-045-105-017

S/L 35  
DEWEY ROBERT ALDRICH  
VOL. 1194 PG. 563  
P.P.N. 15-00-045-105-018

S/L 34  
KATHLEEN L. DAVIS  
INSTR. 980513078  
P.P.N. 15-00-045-105-019

S/L 33  
JOANNA P. RIVERA  
INSTR. 990605935  
P.P.N. 15-00-045-105-020  
N 88°25'28" E  
271.59' REC. & USED

1673.74S 01°00'00" E  
(BASIS OF BEARINGS)

NORTH CENTER ST. (S.R. 301) 60'

WEST MAIN ST. (S.R. 303) 60"

**BOUNDARY SURVEY**  
Charles Lynch  
205 North Center Street  
LaGrange Oh. 44054

Revisions \_\_\_\_\_ Date \_\_\_\_\_

CAMPBELL & ASSOCIATES, INC.  
Surveying & Engineering  
(216) 642-6555  
Independence, Oh. 44131

Date: 2/7/01  
By: WRW  
Scale: 1" = 50'  
Job: 20016002  
Sheet 1 of 1

Copyright © 2001, by Campbell & Associates, Inc.  
All rights reserved.  
No part of this work  
may be reproduced, stored in a retrieval system,  
or transmitted in any form or by any means,  
electronic, mechanical, photocopying, recording,  
or by any information storage and retrieval system,  
without the prior written permission of  
Campbell & Associates, Inc. Requests for  
permission should be addressed to  
Campbell & Associates, Inc.

**LEGEND**

REC. - RECORD DISTANCE OR ANGLE  
CAL. - CALCULATED DISTANCE OR ANGLE  
OBS. - OBSERVED DISTANCE OR ANGLE  
T.P.O.B. - TRUE PLACE OF BEGINNING  
P.O.B. - PLACE OF BEGINNING

■ - MONUMENT BOX  
● - MONUMENT FOUND, SIZE & TYPE AS INDICATED  
○ - 5/8" REBAR, 30 INCHES LONG, WITH I.D. CAP OR SET  
△ - P.K.(MASONRY) NAIL SET

**SURVEY REFERENCE DATA**

PLAT - THE LAGRANGE VILLAGE PLAT RECORD IN VOLUME 1 OF MAPS, PAGE 4 OF LORAIN COUNTY RECORDS.

TAX MAP - LAGRANGE 15-00-045-B

DEEDS - SUBJECT'S DEED VARIOUS ADJONER'S DEEDS

**BASIS OF BEARINGS**

THE BASIS OF BEARINGS FOR THIS SURVEY IS N1°00'00"W ALONG THE CENTERLINE OF NORTH CENTER ST. PER LAGRANGE VILLAGE PLAT VOLUME 1 OF MAPS, PAGE 4 OF LORAIN COUNTY RECORDS.

NOTE: DIMENSIONS SHOWN HEREON ARE GIVEN IN FEET AND DECIMAL PARTS THEREOF.

NOTE: THIS SURVEY WAS PREPARED WITHOUT BENEFIT OF A TITLE REPORT AND NO SEARCH OF THE PUBLIC RECORDS FOR EASEMENTS, RIGHTS-OF-WAYS & ETC.

I HEREBY DECLARE THAT I HAVE SURVEYED THE LAND SHOWN ON THIS PLAT, AND HAVE FOUND OR SET THE PINS AND MONUMENTS SHOWN ON THIS PLAT.

Daniel J. Cook  
CAMPBELL & ASSOCIATES, INC.  
REG. NO. 7179

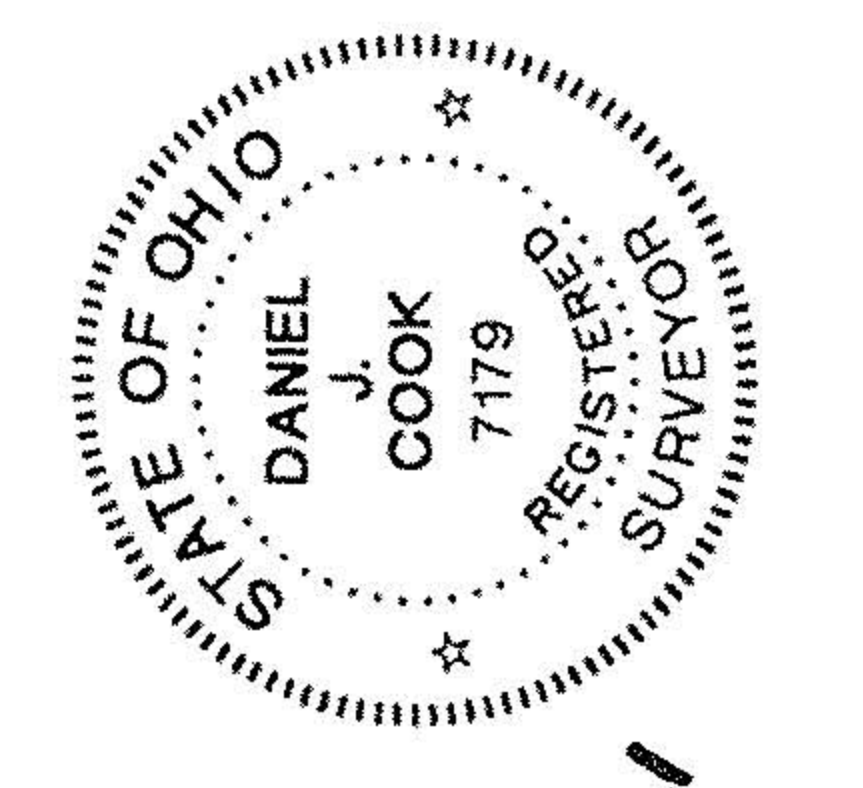

2/7/01  
DJA