

PLAT OF SURVEY

FOR

KATHRYN SEABOLD

STATE OF OHIO, COUNTY OF LORAIN
TOWNSHIP OF LAGRANGE - D.L. 27

N.E. COR. D.L. 27
IRON PIN MON. FD.

IRON PIN SET
(TYP.)

SEABOLD
PAGE 103

KATHRYN
VOL. 1337

N 01° 05' 03" E
400.00'

S 89° 04' 03" E

871.20'

EXISTING HOUSE
N^o 15050

8.0000 ACRES

EXISTING BARN

N 89° 04' 03" W

871.20'

629.50'

S 01° 05' 03" W

400.00'

250.00'

WHEELER ROAD 50'

25.00' E
IRON PIN (TYP.)

N 89° 04' 03" W



SCALE: 1" = 200'

PREPARED BY:

Donald E. Himes 2/24/87

Donald E. Himes & Associates

SITE CONSULTANTS • LAND SURVEYORS

14776 Pearl Road, Strongsville, Ohio 44136

Telephone: (216) 572-2685 or 238-2685

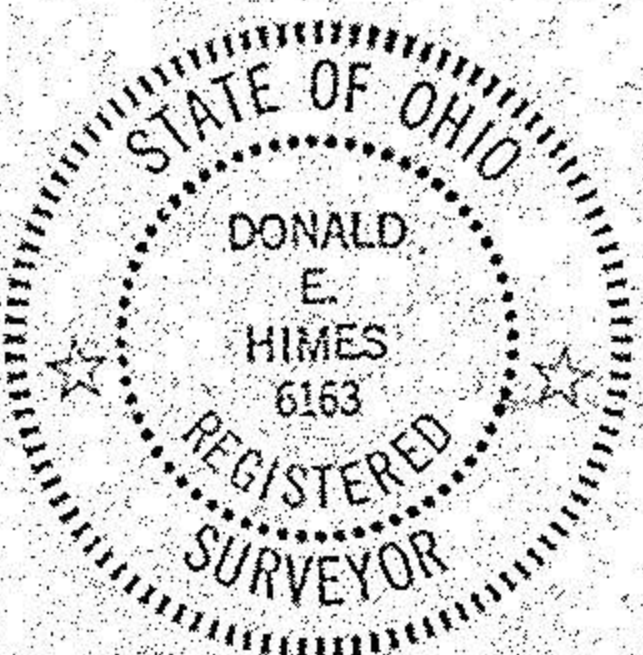

PROJECT N^o 2055