



MON Fd.

PARSONS ROAD

88°53' REC. FUSED

WILMA R. TRAN
O.R.V. 660 P. 728
P.C.L.#2

FENCE CORNER USED

S 89°58'34" E
300.00'

(DEEP Φ)
S-1°40'00"-W
2278.92' REC. F.U.

30.01'

-006
1.3768 AC.
P.C.L. A

N-89°58'34"-W
273.66'
10' DRAINAGE ESMT.

N-1°40'00"-E
200.00'

200.00'
400.00'

NICKLE PLATE DIAGONAL ROAD 60'

300.00
S-89°58'34"-E

-007

1.3768 AC.
P.C.L. B

N-89°58'34"-W
265.85'
10' DRAINAGE ESMT.

N-1°40'00"-E
200.00'

200.00'
S-1°40'00"-W

CREEK

ELK

OL. 1
OL. 20 (APPROX. LOCATION)

N-89°58'34"-W
300.00'

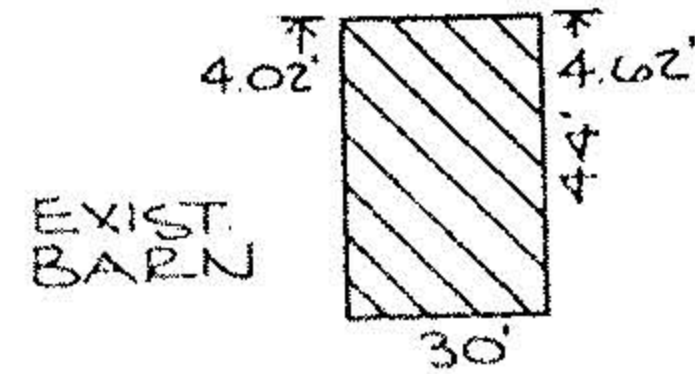

-008
15.00-001-000-005
JOHN T. RATCUL
O.R.V. 687 P. 272
40.00 AC - REC.
(37.25 AC ± - REM)

20950

APPROVED LORAIN CO. MAP DEPT
DATE 7-18-94
PAGE 15-A
BY CAROLYN FRANCIS
#20950

KIPTON-NICKLE PLATE
ROAD

MON Fd.

SURVEY MAP

PART OF ORIGINAL LAGRANGE TOWNSHIP
LOT NOS. 1 AND 20
TOWNSHIP OF LAGRANGE

COUNTY OF LORAIN STATE OF OHIO
MAY 2, 1994 SCALE: 1" = 60'

KS ASSOCIATES INC.
ENGINEERS SURVEYORS

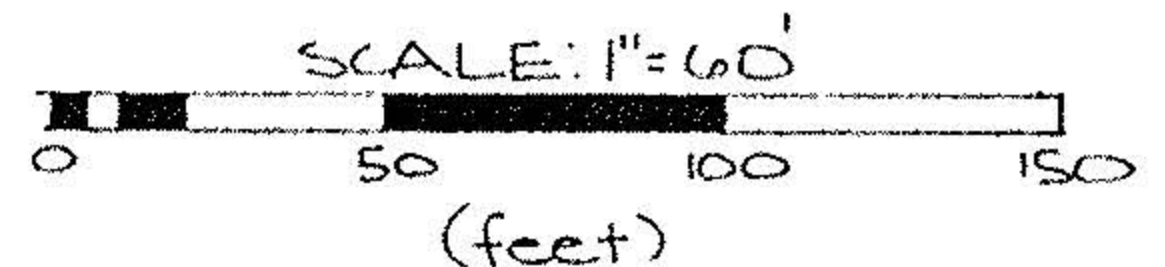

David L. Elwell
REG. SURV. NO. 6333