

21957

APPROVED	
LORAIN CO.	
MAP DEPT.	
DATE 10-23-96	
PAGE 15-A	
BY K. DYE	
VOID AFTER #	21957

Parsons Rd

OR 660 Pg 228

Wilma R Tran

S 89° 58' 34" E

30

5 10-40' W

2478.92 Rd

200100
300100'

300100'

Thomas A & Julie L
Paramore

OR 1242 Pg 872

1.354 Acres

200100'
S 10-40' W

290100'

300100'

30

N 89° 58' 34" W

Gary Beckett &
Deborah Bush

OR 1063 Pg 730

1.277 acres
Total
21018 AC 14
06 20

266.60'

200100'

Nickle Plate Diagonal

136.60

300100'

30

N 89° 58' 34" W

John T Ratcliff
OR 687 Pg 572

011
0220

West bank of creek
Eik Creek

N 10° 11' 52" W
199.95

N 5° 01' 31" W
200169'

11.92

- monument box
- iron pipes fd
- iron pins set

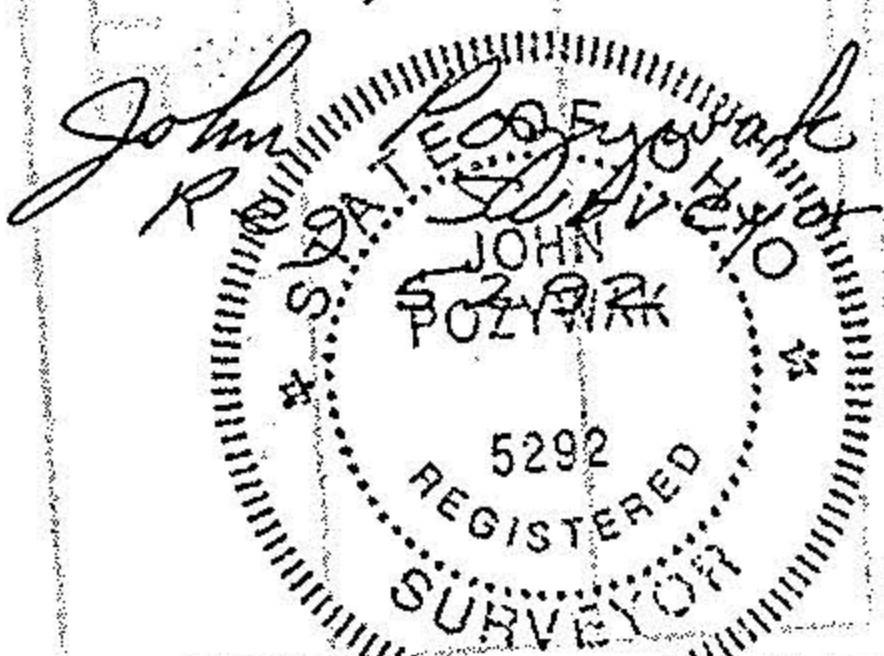

Survey of Parcel Splits
 Gary Beckett
 Original Lot 1 & 20
 LaGrange Township
 Lorain County, Ohio
 Scale 1"=100' Sept 1996

