

- NOTES: \square indicates iron pin found in monument box.
 ○ indicates iron pin set January - 1974.
 ● indicates iron pin set this survey unless otherwise designated.

Marvin A. & Jennie E. Gehring - Remaining Land

RRS set
30'

282.38' 317.54' 327.13' 957.05'

N. 89° 47' 55" E.

15-00-058-000-018

6.0394 ACRES

0.L. 58
S. 89° 47' 55" W.
326.3' 350.0' 956.30' 250.0'

Michael L. & Carolyn S. Miller 0.L. 63

D. Vol. 1093 Pg. 866

PLAT OF SURVEY FOR
 MARVIN A. & JENNIE E. GEHRING
 ORIGINAL LOT 58 LAGRANGE TWP.
 LORAIN COUNTY OHIO
 SCALE: 1" = 100' OCTOBER 23 - 1976

Gary E. Penfound
 Reg. Surveyor No. 4457

N. 0° 04' 50" E.
275.00'
273.49'

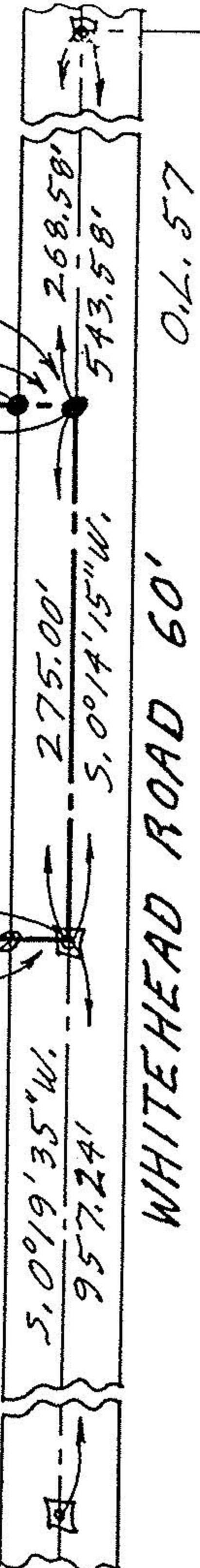
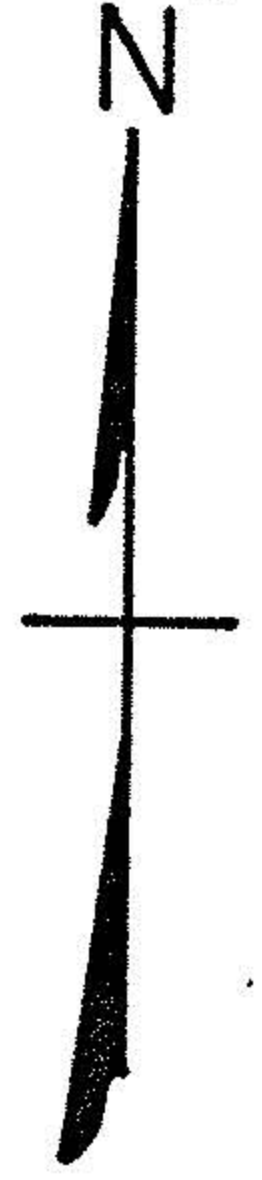

WHITEHEAD ROAD 60'