

RURAL LORAIN COUNTY WATER AUTHORITY
DEED VOL. 1120, P. 118

10.201 AC. SPLIT

WAKEMAN-LAGRANGE-
RICHFIELD RD. (S.R. 303) 60'

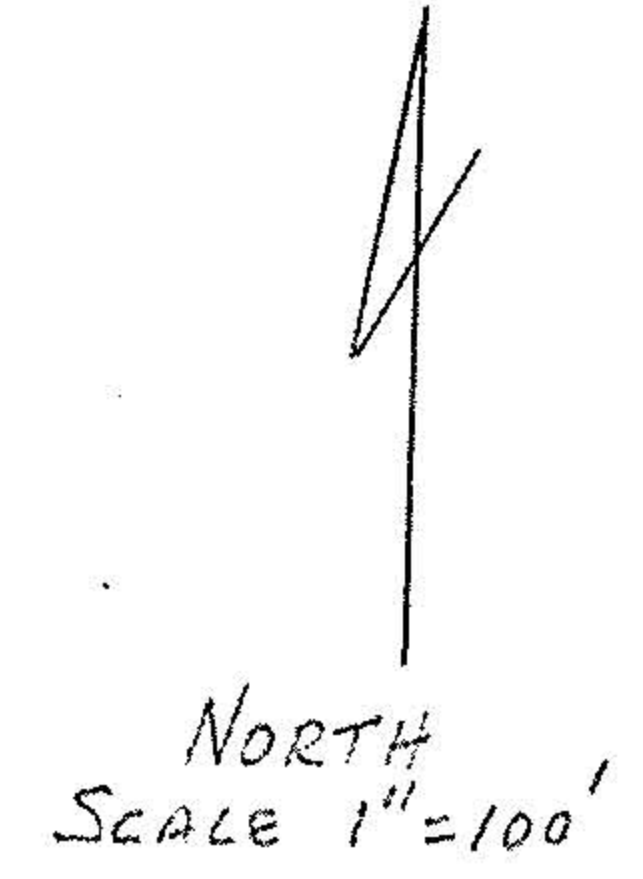

G. + E. BURNETT
ORIG. REC. VOL. 149, P. 523
60.59 AC. ORIG.
50.389 AC. REM.

#18358

APPROVED LORAIN CO. MAP DEPT.	
DATE	3-21-89
PAGE	15-E
BY	Carol Francis
VOID AFTER #	18358



MAP OF SURVEY OF 10.201 AC. SPLIT FOR
RURAL LORAIN COUNTY WATER AUTHORITY
D.L. 5B - LAGRANGE TWP. - LORAIN CO.
3/89
JOHN R. HAMILTON
SCALE 1" = 100'