

No 0 1138

APPROVED LORAIN CO. MAP DEPT
DATE 7-10-02
PAGE 13-11-028-D
BY J Hatfield
#02-01138

owner: Patrick J & Connie M Blewitt  
# 990601026

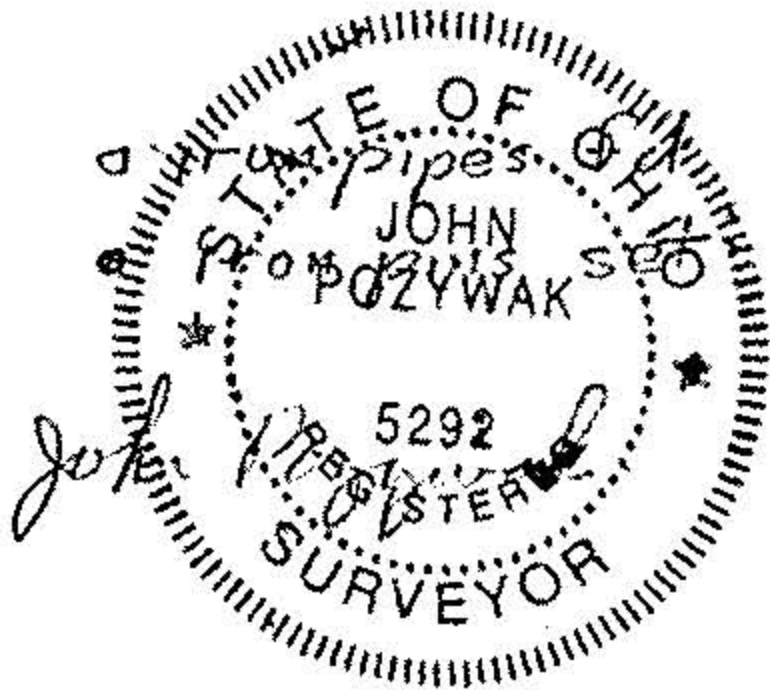

Survey of Parcel split  
for Connie Blewitt  
Original Lot 28 Tract 11  
Camden Township  
Lorain County Ohio  
Scale 1"=200 June 2002