

PLAT OF SURVEY FOR

JERRY D. & TONI HARDWICK

ORIGINAL LOT NO. 12 - TRACT NO. 9
CAMDEN TWP. - LORAIN COUNTY - OHIO

SCALE: 1" = 100' OCTOBER - 1977

Gary E. Penfound Reg. Surveyor No. 4457

NOTE: ● indicates iron pin set on this survey.

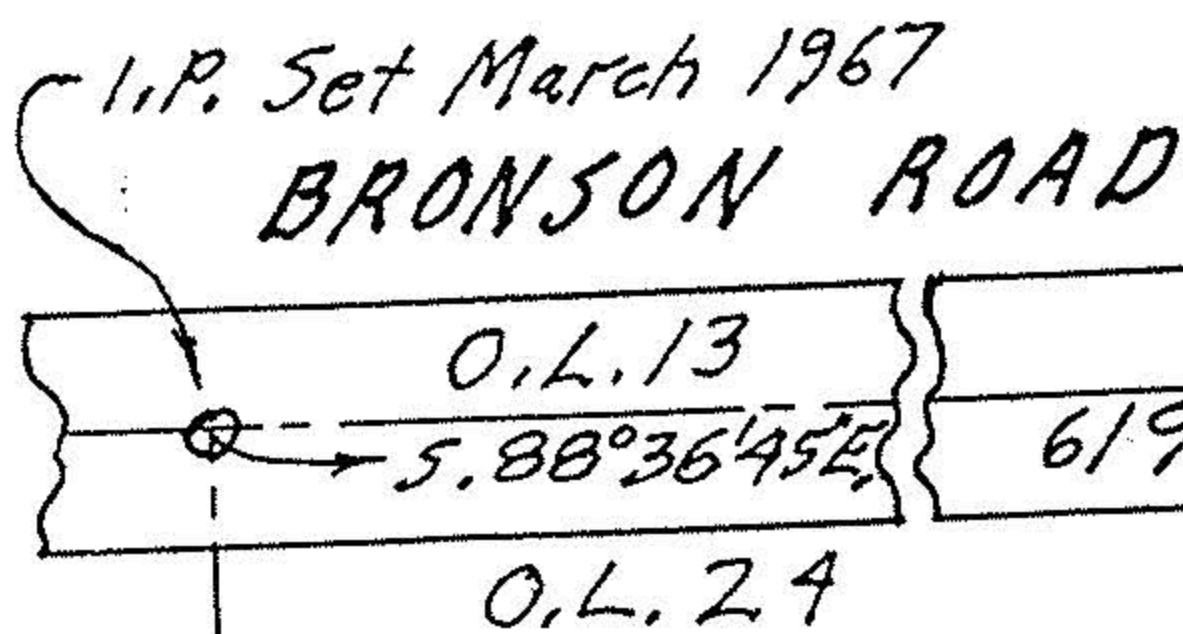

GIFFORD ROAD

