

012 437 Pg 310
Kenneth Jordan

Jean E Hollingsworth

3.134 Acres

Jean E Hollingsworth
OR 437 Pg 313

139.43'

242.06'

381.49'
S 87° 14' E

2.657 Acres

N 10° 30' E

180.00'

180.00'

Rowell Rd

S 10° 30' W

30' Barn

N 88° 17' W 30' offset
381.40'

Albert E & Arlene Pycraft
Trustee

99 067972

OL 29

99 067972

OL 44

Albert & Arlene Pycraft

- o iron pins fd
- o iron pins set

Survey of Parcel Split
Original Lot 29 Tract 9
Camden Township
Lorain County Ohio
Scale 1"=100' February 2001
John Pozzywak

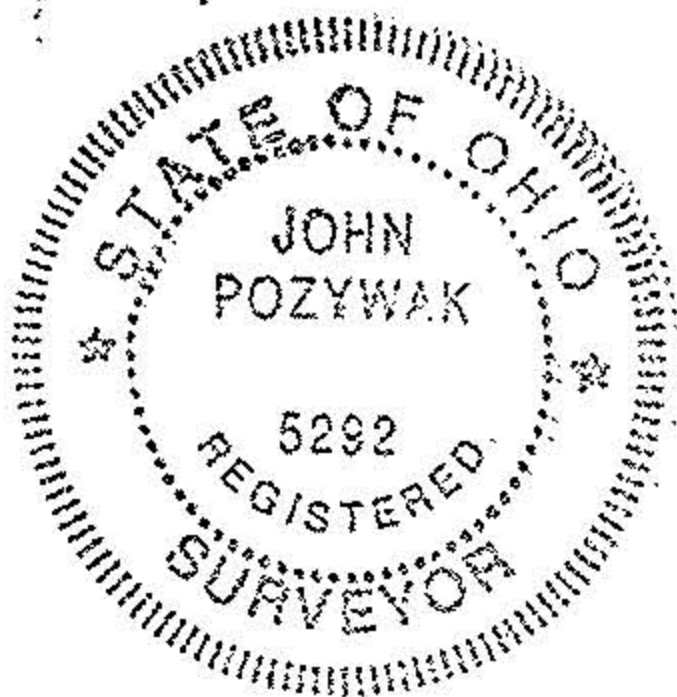

00706

APPROVED LORAIN CO. MAP DEPT
DATE 4-5-01
PAGE 13-H
BY JHATFIELD
#01-00706