

Kpt in Rd
north of new
split

center of
culvert

Harlan Schramm

Remainder by Auditor
12.61 Acres

Donald Schramm
DIV 1185 Pg 596

N 87°59'E 725.78'

Open ditch

- O Z T
61295 Acres

N 86°25'W
725.100

DIV 114
Pg 250
Virginia Braun
DIV 1217
Pg 640

44.00'

S 10°25'W

Wayne H & Beverly Schramm
DE 674 Pg 167

3143

11100
BELL



21421

APPROVED
LORAIN CO.
MAP DEPT

DATE 7-20-95

PAGE 13-B

BY CAROLYN
FRANCIS

21421

Baird Rd

N 1025'E 3431.00'
25150'
200.00'
2480'
N 1053'E 468.40'
190.90'

center of Bridge

SR 303
Wakeman Belden Rd

Survey of NIMON
Parcel split for Ken Diamond

Original Lot 30 Tract 10
Camden Township
Lorain County Ohio
Scale 1" = 200 Oct 1994

- o iron pipes fd
- iron pipes set
- Monument Box

John Poznywak
Reg Surveyor
5292

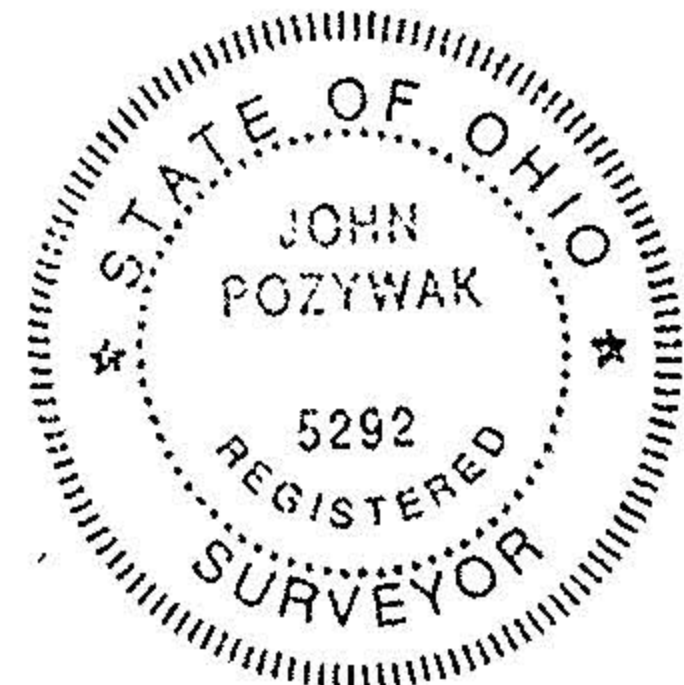

13-10-030-000-