

PLAT OF SURVEY

MADE FOR
PETER A. JR. & IRENE M. BORLING
 DEED RECORDED IN INSTRUMENT № 20000722405

BEING PART OF ORIGINAL COLUMBIA TOWNSHIP LOT 90
 COLUMBIA TOWNSHIP, LORAIN COUNTY, OHIO

P.P.N 12-00-090-000-020, -033 thru -035

No 01109

APPROVED LORAIN CO. MAP DEPT
DATE 6-13-02
PAGE 12-E
BY JHatfield
#02-01109

I DECLARE THIS PLAT TO BE A TRUE REPRESENTATION OF AN ACTUAL FIELD SURVEY MADE BY ME IN MAY, 2002. DISTANCES ARE GIVEN IN FEET AND DECIMAL PARTS THEREOF. NORTH DATUM USED IS THE BEARING OF RECORD FOR THE CENTER-LINE OF STATION ROAD.

- INDICATES 5/8" & 1/8" IRON PIN, 30" LONG, WITH "ZWICK" CAP, SET
- ◄ INDICATES MAG. NAIL SET

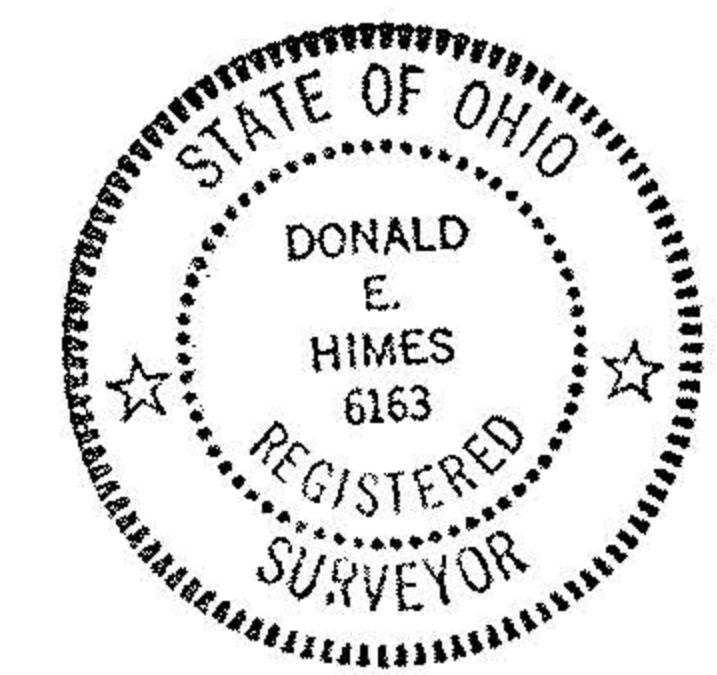

Donald E. Himes
 DONALD E. HIMES, P.S. # 6163
ZWICK ASSOCIATES, INC.
 ENGINEERS - SURVEYORS - PLANNERS
 8150 STEARNS ROAD, DIMSTED TOWNSHIP, OHIO 44138
 TEL: 440-235-2729 FAX: 440-235-0604

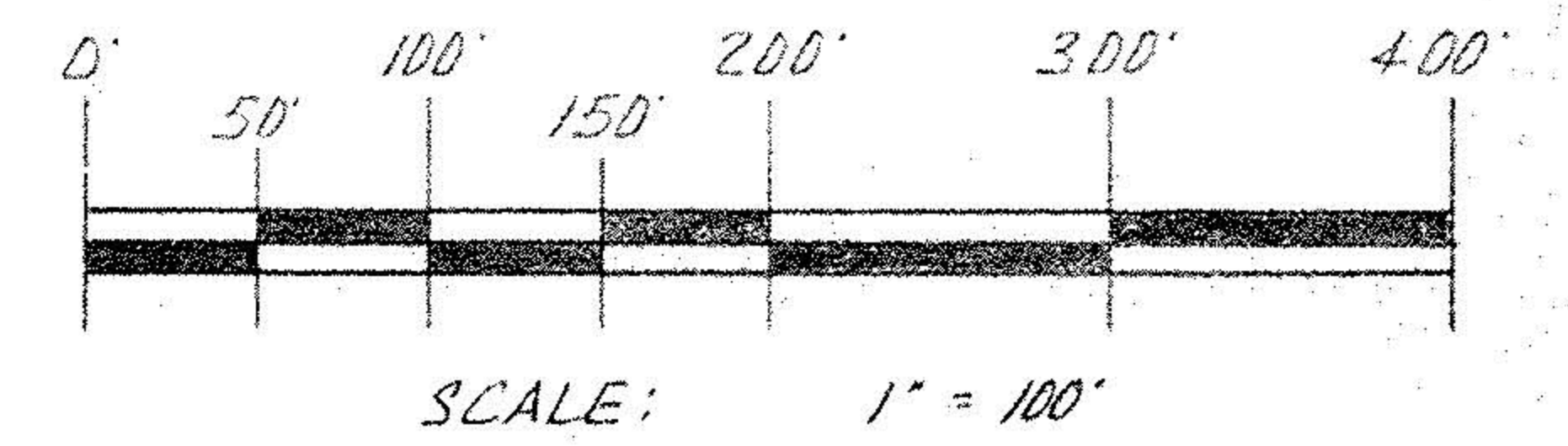

LORAIN COUNTY
 MEDINA COUNTY