

50501 P 1 528 Pg 220

Paul & Barbara Jakubisin D.V. 1119 Pg 871  
N 89° 41' 15" E

Store Pillar  
Eproove Rd

618.95

231.40'

Wanda E Mirrell  
D.V. 1184 Pg 796

-060

10.781 Acres

-061

5.030 Acres

Jerry C &  
Judith E  
Sine  
OR 392 Pg 558

- Monument boxes
- iron pipes & d
- iron pins set



02 100 N 0° 31' 35" W  
02 81 618.03'

N 0° 32' E  
496.26'

50° 32' W  
138.00'

X 179.47'  
N 89° 41' 15" E

493.15' N 89° 41' 15" E

100.00' 194.03'

216.18' 167.06'

11° 00' 32" E 167.06'

50° 28' 46" E 167.06'

126.40' 168.05'

N 86° 17' 20" W 284.45'

705.00'  
S 89° 59' W

Mitchell Rd

1317.52'  
S 89° 59' W  
N 89° 59' E

-062

7.715 Acres

N 89° 59' E  
640.00'

3.707 Acres

N 0° 32' E  
253.56'

S 89° 59' W  
640.00'

Benjamin C & Carolyn Theodas  
D.V. 1209 Pg 514

673.60'  
1313.60' ±  
02 81  
02 82

N 0° 32' E  
125.00'  
125.00'

Survey of Parcel Splits  
Original Lot 81 Columbia Township  
Lorain County Ohio

Scale 1" = 100' July 1995

John Pozywak  
Reg Surveyor 5292

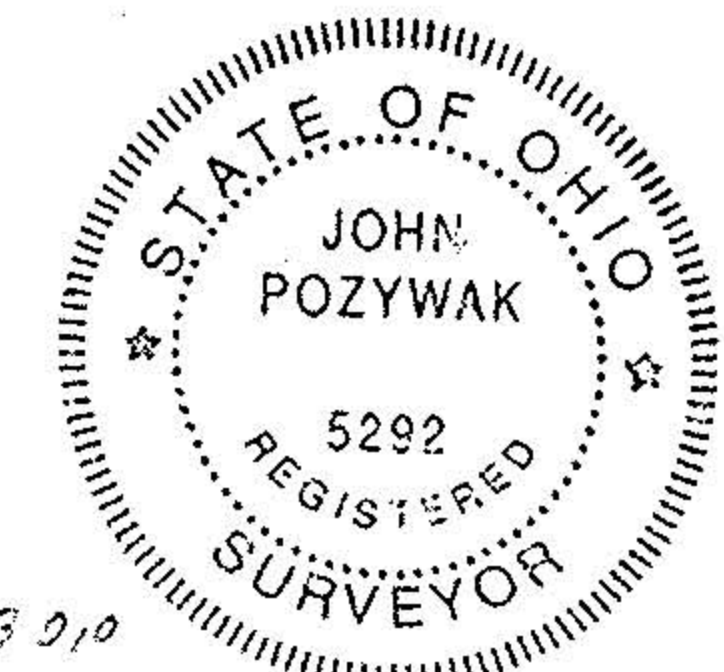

7/25/95