

13-A

MAP OF SURVEY FOR STEVE MATUS
CAMDEN TWP. - TRACT #11 - O. LOT # 21
JULY 1989

#18562 13-11-021-000-021

TRACT 11
O.L. 21



STEVE J. + GRACE F.
MATUS O.R. 4, P.001
9.95 AC. ORIG.
8.192 AC. REM.

STEVE J. + GRACE F.
MATUS DEED VOL. 467, P.24
2.63 AC. ORIG.
1.616 AC. REM.

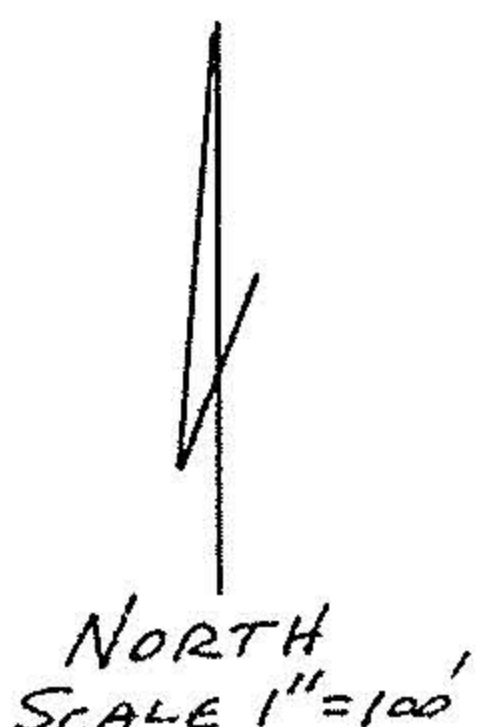

160.00' DUE NORTH
IP SET

700.00'
S 87° 33' E

1.758 AC. SPLIT

479.00'
N 87° 33' W

BERNARD G. +
SALLY GADOMSKI
DEED VOL. 1214 P.19

MARTIN J. +
GARNET M. MATUS
DEED VOL. B27 P.100

1.014 AC. SPLIT

221.0'
N 87° 33' W
P.M. + E.E. MATUS
DEED VOL. 1254 P.432

JOHN R. HAMILTON
REG. SURV. #6861

500.00' TO U.S. 20
200.00' IP SET
318.00' GORE OR PHANAGE RD. (60') DUE SOUTH
IP SET

#18562

APPROVED
LORAIN CO.
MAP DEPT.

DATE 8-4-89

PAGE 13-A

BY T. McVain

VOID AFTER 18562