

DISTANCES ARE IN FEET & DECIMAL PARTS THEREOF. BEARINGS ARE BASED ON AN ASSUMED MERIDIAN & ARE GIVEN FOR THE PURPOSE OF DESCRIBING ANGLES ONLY. MONUMENTS WERE FOUND OR SET AT ALL POINTS INDICATED, ALL OF WHICH I CERTIFY TO BE CORRECT TO THE BEST OF MY PROFESSIONAL INFORMATION & BELIEF. CERTIFIED COPIES ARE ONLY THOSE SIGNED IN RED INK.

*Richard A. Rosebeck*

RICHARD ROSEBECK SURV. NO. 7400

APRIL 1994



SCALE 1" = 30'

LAKE BREEZE MANOR SUB NO. 3 IP SET

IP SET

X 95.04' X

S/L 65

S/L 64

PARCEL "A"  
0.2714 AC

DUE WEST

(124.09')

DISTANCES

DRILL HOLE SET IN CONC SIDEWALK

IP SET

X

S/L 63

100' - 042 - 015

124.70'

96

21.84

15'

IP SET

95.04' X

X 94.66'

S/L 62

PARCEL "B"  
0.2722 AC

125.30'

X 95.04'

IP FOUND

FERNDALE AVE. S. N 89° 49' 30" E

20916

APPROVED LORAIN CO. MAP DEPT.

DATE 7-6-94

PAGE 300-041A

BY CAROLYN FRANCIS

VOO #20916

COMMUNITY DR. 50'

DUE NORTH

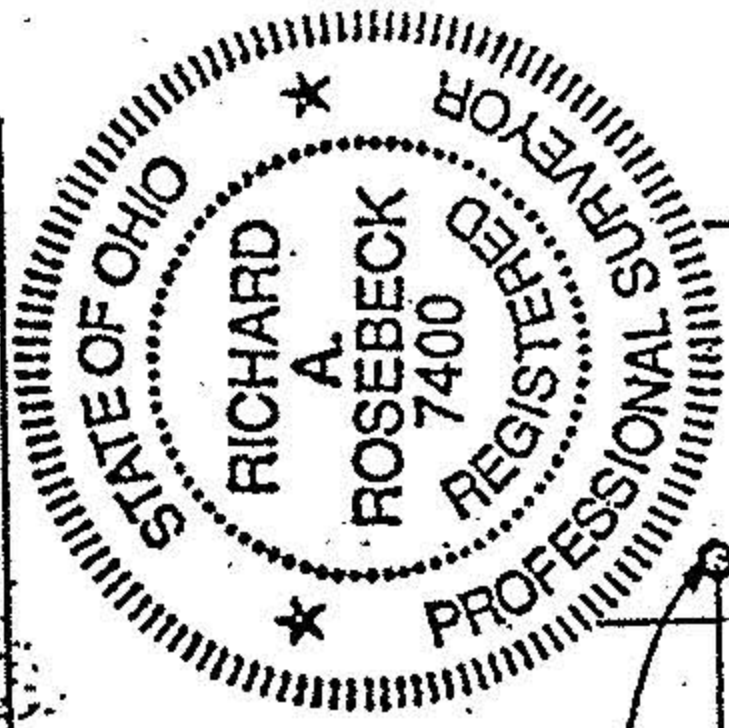

LOT COMBINATION & SPLIT FOR

KEN SCHUTZ

SITUATED IN THE CITY OF SHEFFIELD LAKE, COUNTY OF LORAIN AND STATE OF OHIO AND KNOWN AS BEING PART OF ORIGINAL SHEFFIELD TOWNSHIP LOT NO. 41 AND FURTHER KNOWN AS BEING SUBLOTS L1 TO L6 OF COMMUNITY BEACH SUBDIVISION AS RECORDED IN VOL. 11 P. 142 OF THE LORAIN COUNTY MAP RECORDS