

MAP OF SURVEY & PARTITION

SOUTH BOONE ROAD 60'

EMMONS RD. 60'

LEONARD S. & CHERYL J. OLIVERI

SITUATED IN THE OF TOWNSHIP OF COLUMBIA, COUNTY PART OF THE STATE OF OHIO AND KNOWN AS BEING PART OF ORIGINAL COLUMBIA TOWNSHIP, LOT NO. 28.

ACCEPTANCE:

WE, LEONARD S. OLIVERI AND CHERYL J. OLIVERI, OWNERS OF THE LAND SHOWN HEREON DO HEREBY ACCEPT THIS SURVEY AND PARTITION OF THE SAME.

WITNESS

LEONARD S. OLIVERI

WITNESS

CHERYL J. OLIVERI

COUNTY OF LORAIN } s.s. BEFORE ME A NOTARY PUBLIC IN AND STATE OF OHIO } AND PERSONALLY APPEARED IN AND FOR SAID COUNTY AND STATE OF OHIO } LEONARD S. OLIVERI AND CHERYL J. OLIVERI WHO HAVE SIGNED THESE INSTRUMENTS AND WHOSE NAMES AND ADDRESSES ARE SET FORTH IN THE INSTRUMENTS AND WHOSE SIGNATURES AND SEALS I HAVE HEREONTO SET MY HAND AND OFFICIAL SEAL AT _____ OHIO THIS _____ DAY OF _____ 1986.

NOTARY PUBLIC

COMMISSION EXPIRATION

APPROVAL:

THIS PLAT IS APPROVED BY THE LORAIN COUNTY PLANNING COMMISSIONER THIS _____ DAY OF _____ 1986.

JOHN HALL
LORAIN COUNTY PLANNING
COMMISSIONER

DISTANCES SHOWN HEREON ARE GIVEN IN FEET AND DECIMAL PARTS THEREOF BEING TO AN ASSUMED MEAN DIAN OF WHICH ALL ANGLES ARE TO BE CORRECT.

#17169

APPROVED	BY	DATE	PAGE	VOID AFTER
LORAIN CO. MAP DEPT.	T. McManis	12-22-86	12-G	

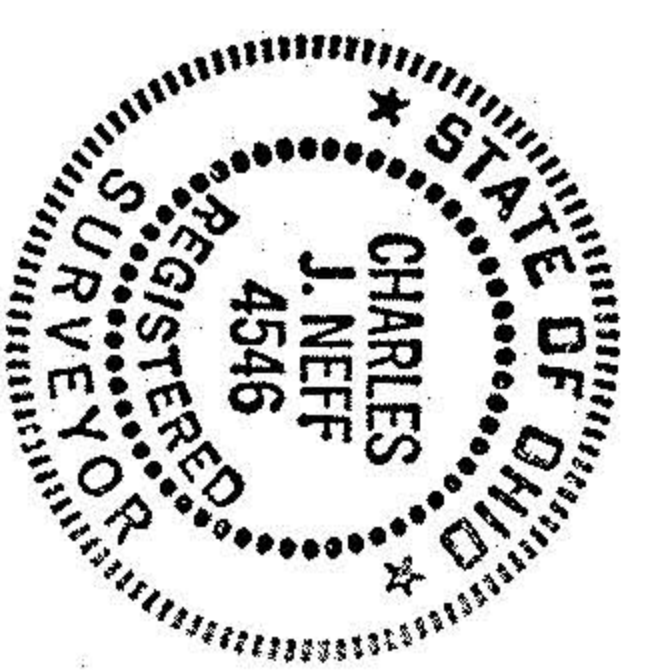

CHARLES J. NEFF
REG. SURVEYOR NO. 4546 - OHIO

PREPARED BY
NEFF & ASSOCIATES, INC.
CONSULTING ENGINEERS & SURVEYORS
6415 STUMPH ROAD
PARMA HEIGHTS, OHIO 44130

15-G

15-00-058-000

