

LAKE ROAD - 66'

NORTH

SCALE: 1"=10'

McGLINCHY and ASSOCIATES
PROFESSIONAL ENGINEER & SURVEYORS
110 1/2 MAPLE AVE. ELYRIA, OHIO
OCTOBER, 1980 #804553
REV. 11-10-80

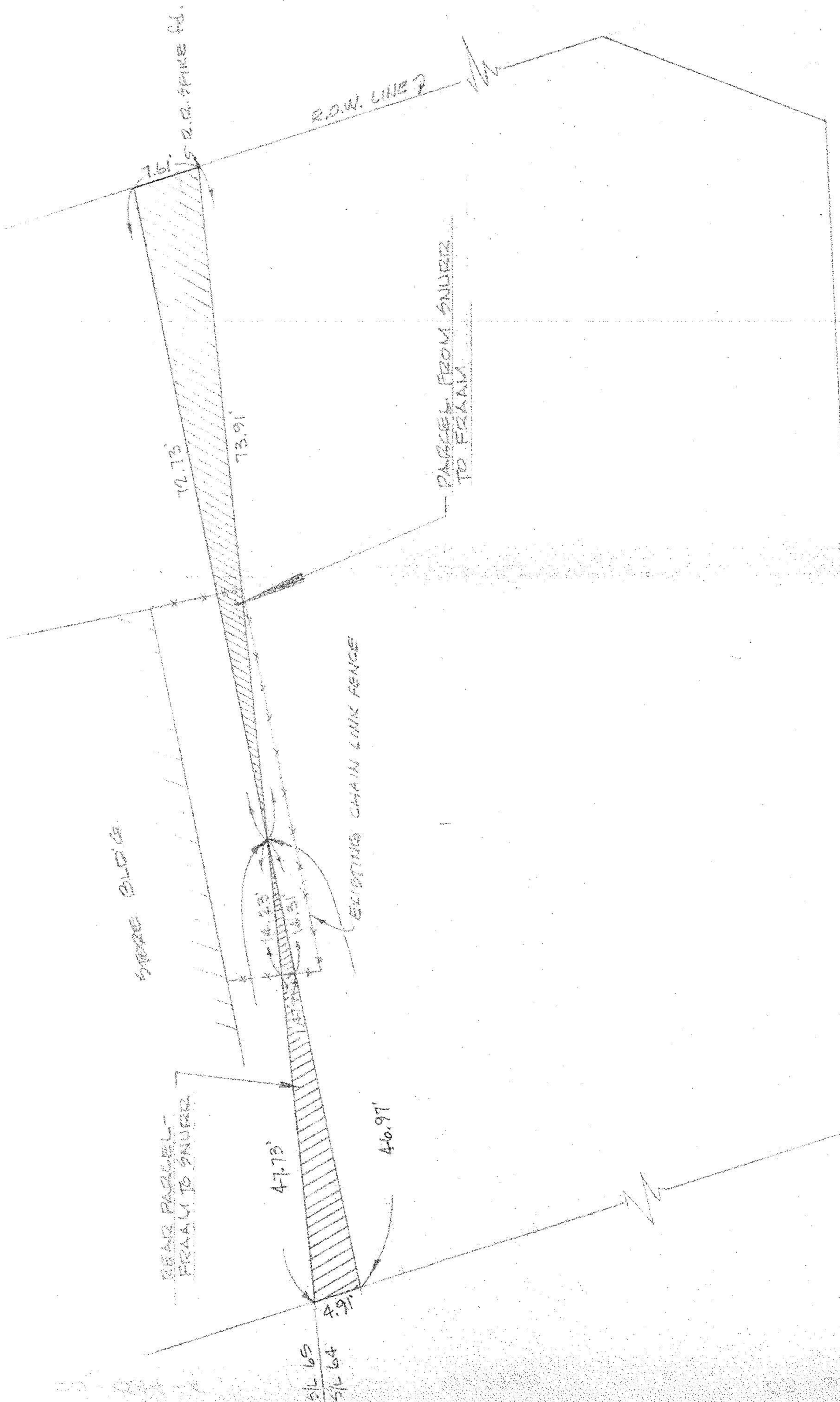

ABBE ROAD

MAP of SURVEY
PREPARED FOR GEORGE FRAM
PART of ORIGINAL SHEFFIELD TWP LOT 34
CITY of SHEFFIELD LAKE, LORAIN COUNTY, OHIO

DATE	10-1-80
BY	WV DEPT
DATE	10-1-80
BY	FORNIN CO
DATE	10-1-80
BY	APPROVED

113000