

3-00-033-B

3-00-033-B
03-00-033-118-058

1" = 30'



COVE BEACH AVE. 48'

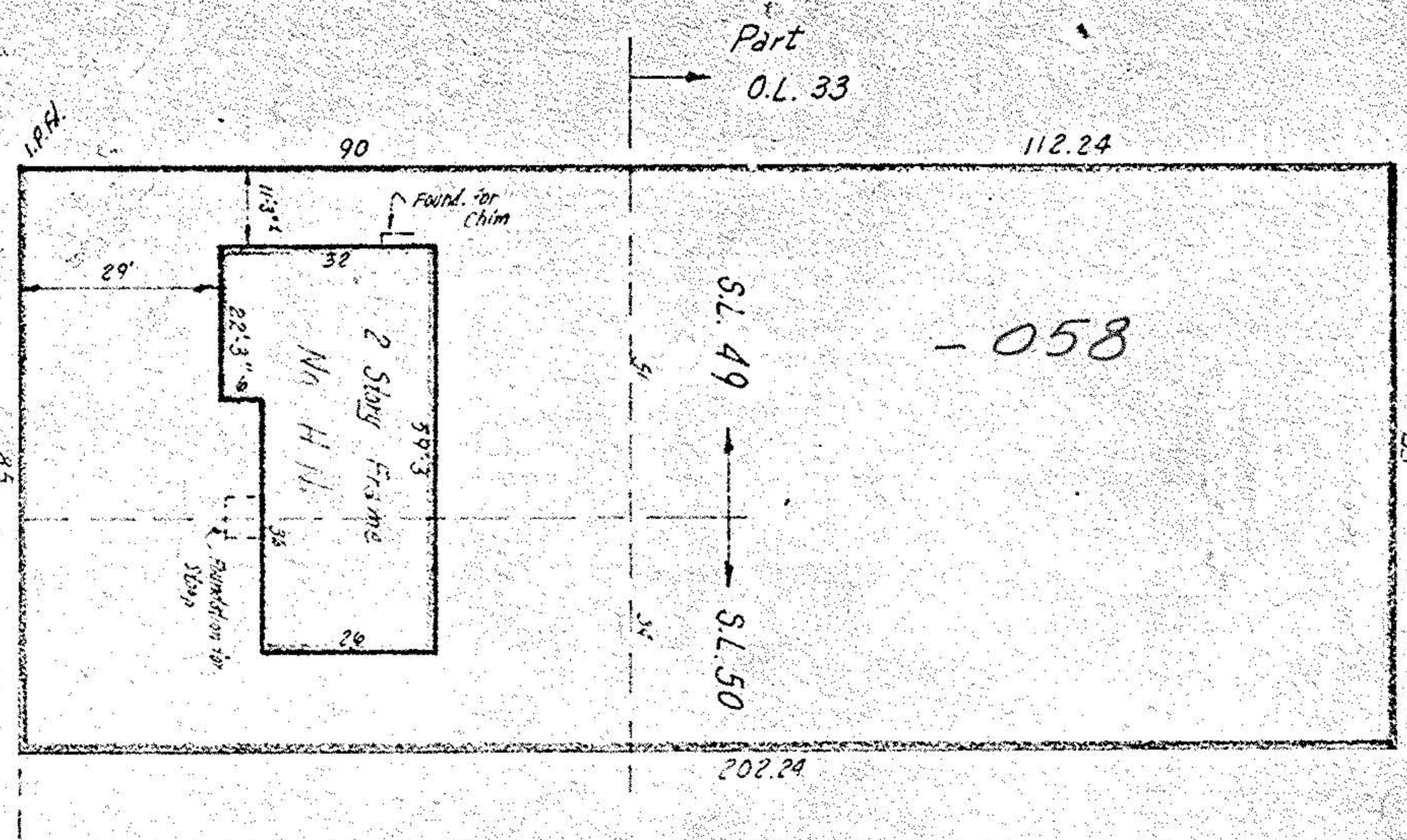

PART of SUBLLOT # 50 plus ALL of
 SUBLLOT # 49 of COVE BEACH ALLOTMENT
 PLAT VOL. II PAGE II plus
 PART of ORIG. SHEFFIELD TWP. LOT 33
 NOW in CITY of SHEFFIELD LAKE, OHIO

#11751	APPROVED
	LORAIN CO. MAP DEPT.
	DATE 6-14-78
	PAGE 3-00-033-B
	BY T. McLaw
VOID AFTER	

THIS IS NOT A PLAT OF SURVEY:
 FOR MORTGAGE LOAN PURPOSES ONLY

McGLINCHY & ASSOCIATES

FEB. 14, 1978

*772534

ST-L-8126