

3-00-033-B

3-00-033-B
03-00-033-118-058

1" = 30'



COVE BEACH AVE. 48'

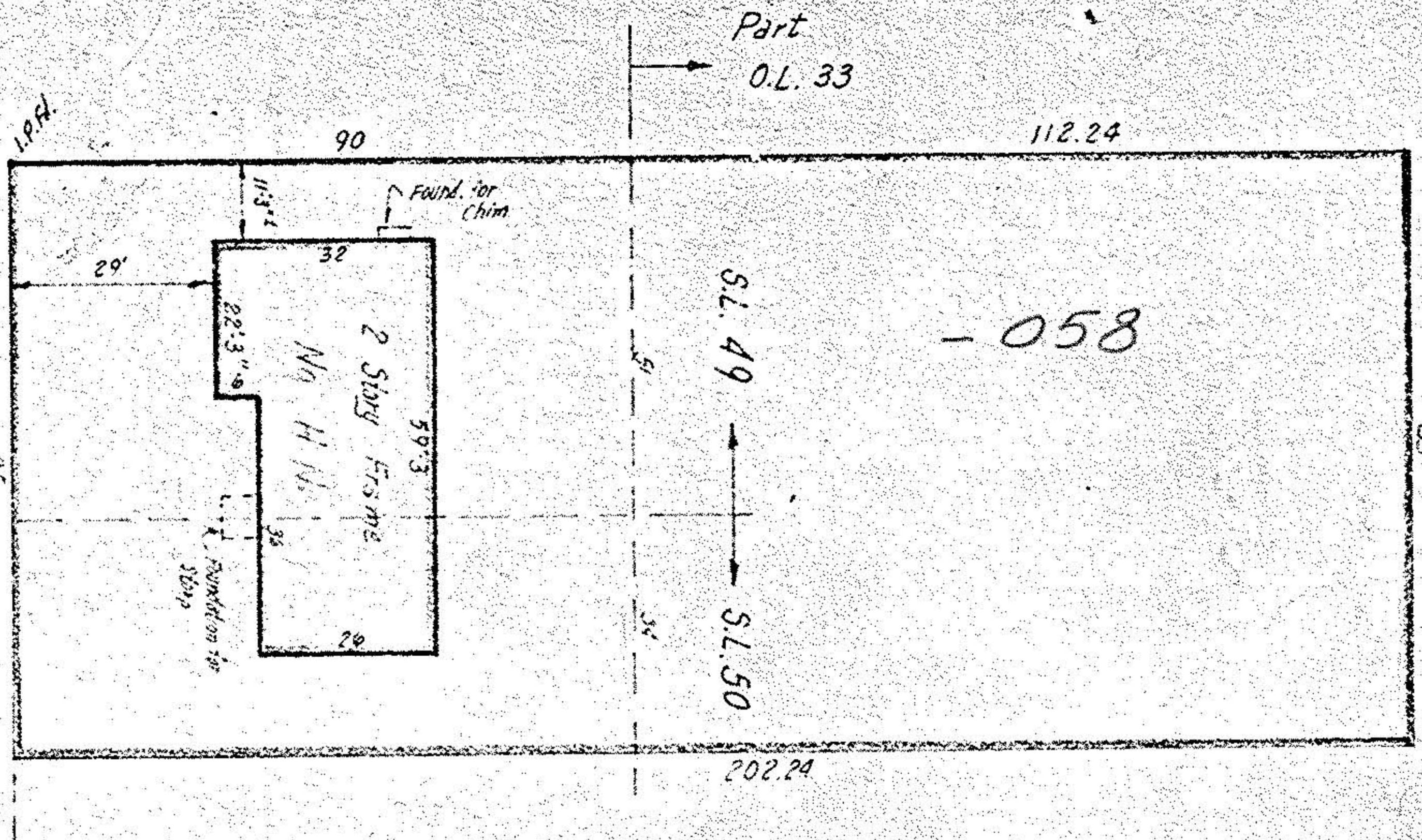

PART of SUBLLOT # 50 plus ALL of
SUBLLOT # 49 of COVE BEACH ALLOTMENT

PLAT VOL. II PAGE II plus
PART of ORIG. SHEFFIELD TWP. LOT 33
NOW in CITY of SHEFFIELD LAKE, OHIO

#11751	APPROVED	DATE 6-14-78	BY T. McNeil
	LORAIN CO. MAP DEPT.	PAGE 3-00-033-B	VOID AFTER

THIS IS NOT A PLAT OF SURVEY:
FOR MORTGAGE LOAN PURPOSES ONLY

McGLINCHY & ASSOCIATES
FEB. 14, 1978 *772534
ST-L-8126