

PLAT OF SURVEY - PARCEL SPLIT

SITUATED IN THE STATE OF OHIO, COUNTY OF LORAIN, TOWNSHIP OF COLUMBIA, LOT N^o 3

MADE FOR: **HELEN E. COOK**
VOLUME 1310 PAGE 308

- # 16961
- # 17006
- # 17079
- # 17100



● INDICATES IRON PIN FOUND & USED UNLESS OTHERWISE NOTED
○ INDICATES IRON PIN SET

IRON PIN FOUND & USED AT THE NORTHWEST CORNER OF LOT N^o 3

PAUL H. 999 & GLOWN M. SHEARER
PAGE 29
THIS PARCEL SURVEYED IN DECEMBER, 1909
BY JOHN R. HOY.

PARCEL N^o 1 6.8626 ACRES

PARCEL N^o 2 7.0352 ACRES

PARCEL N^o 3 7.0418 ACRES

PARCEL N^o 4 7.0376 ACRES

PARCEL N^o 5 10.6658 ACRES

GEORGE & RONDA M. KLINK
PAGE 523

REDFERN

PREPARED BY: 1-5-87

Donald E. Himes & Associates

SITE CONSULTANTS • LAND SURVEYORS

14776 Pearl Road, Strongsville, Ohio 44136
Telephone: (216) 572-2685 or 238-2685

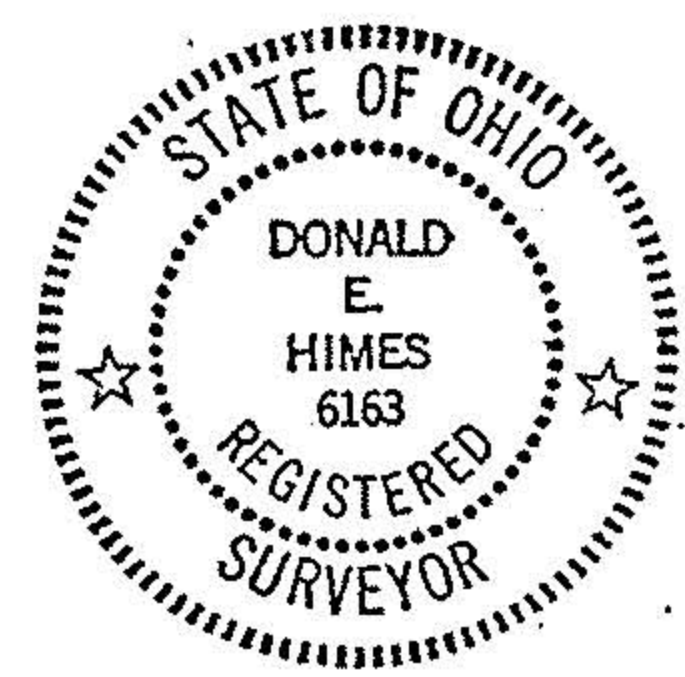

APPROVED
LORAIN CO.
MAP DEPT.
DATE 11-14-86
PAGE 12-00-003-A&B
BY T. McMain
VOID AFTER

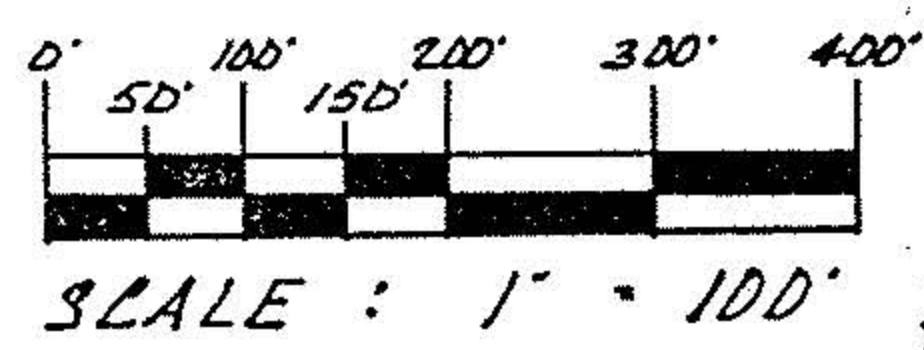

IRON PIPE FOUND (D. DEED) & USED AT CENTERLINE INTERSECTION

WITH MY SIGNATURE HEREDU I CERTIFY THIS PLAT TO BE A TRUE REPRESENTATION OF AN ACTUAL FIELD SURVEY MADE BY ME IN JANUARY, 1986. DISTANCES ARE GIVEN IN FEET AND DECIMAL PARTS THEREOF. NORTH DATUM IS THE BEARING OF RECORD FOR THE WEST LINE OF LOT N^o 3.

Donald E. Himes 1/18/86