

#22195

APPT ( )
LORAIN CO.
MAP DEPT
DATE 5/30/97
PAGE 12-00-014-A
BY K. Colbert
#22195

Squires Rd

Boone Rd

N 0°17'20"E

230100'

30.0

N 89°27'20"E

550,00

Michael G &  
6.1007 Ac Cynthia M  
OR 1153 MUSTO  
Pg 544

520,100'

260,000'

N 89°27'20"E

33511'

21000 Ac

260,100'

N 0°17'20"E

55,100'

1070,100'

30114' N 89°27'20"E

33511'

0214  
0213

Paul A & Kathleen Heckko

① 30100' N 0°17'20"E

- Monument box
- iron pins set
- iron pins fd

20ft Easement

Survey of Parcel Split  
Original Lot 14  
Columbia Township  
Lorain County Ohio  
Scale 1" = 200' Dec 1996

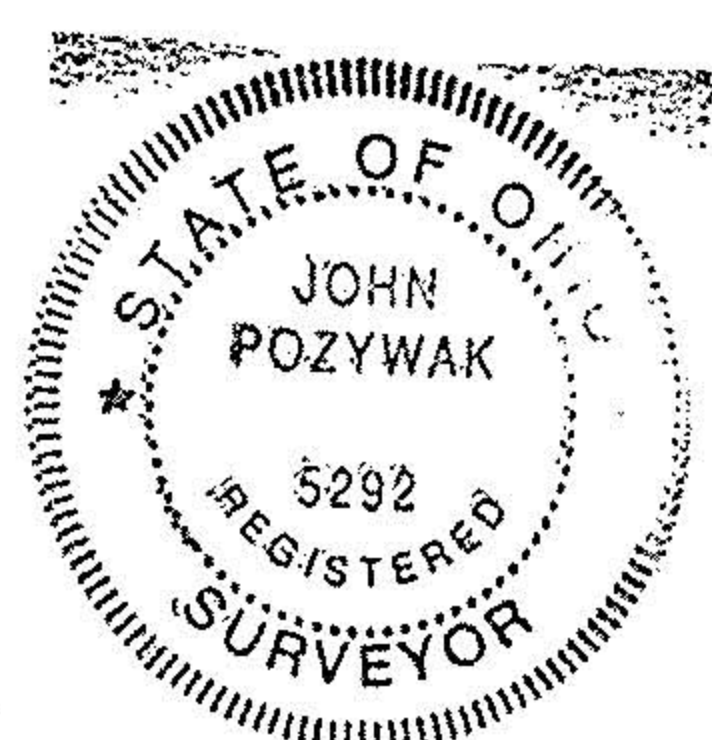

John Pozywak  
Reg Surveyor 5292

