

Numbers:
 50-07-00-014-104-004
 50-07-00-014-104-024
 Merged into:
 50-07-00-014-104-032

SCALE: 1" = 100'
 JULY 13, 1982
 REV. OCT. 7, 1982



#18145
 APPROVED
 LORAIN CO.
 MAP DEPT.
 DATE 9-28-88
 PAGE 7-00-014A
 BY *J. Fairbert*
 VOID AFTER 18145

HAROLD D. & LORNA I. SWEET
 Calc. 337.02'

0.455 A.

ROUTE

STATE OF OHIO
 PCL. 241-WL
 D.V. 1112 P. 704
 3.54 A.

LEONA AUSTIN (LOEPP)
 D.V. 838 P. 575
 (6.25 A.)

1.450 A.

0.612 A.

House N-57°14'12"E 402.87'
 Barn S-51°19'30"W 369.56' Pac.
 369.63 Calc.

SAMUEL CHAS. MOORE JR. &
 PATRICIA MOORE
 D.V. 1005 P. 576 0.82 A.

JOHN A. & ESTHER WORCESTER

BOUNDARY SURVEY

OF PART OF RIDGEVILLE TOWNSHIP

ORIGINAL LOT NO 14

CITY OF NORTH RIDGEVILLE COUNTY OF LORAIN
 STATE OF OHIO

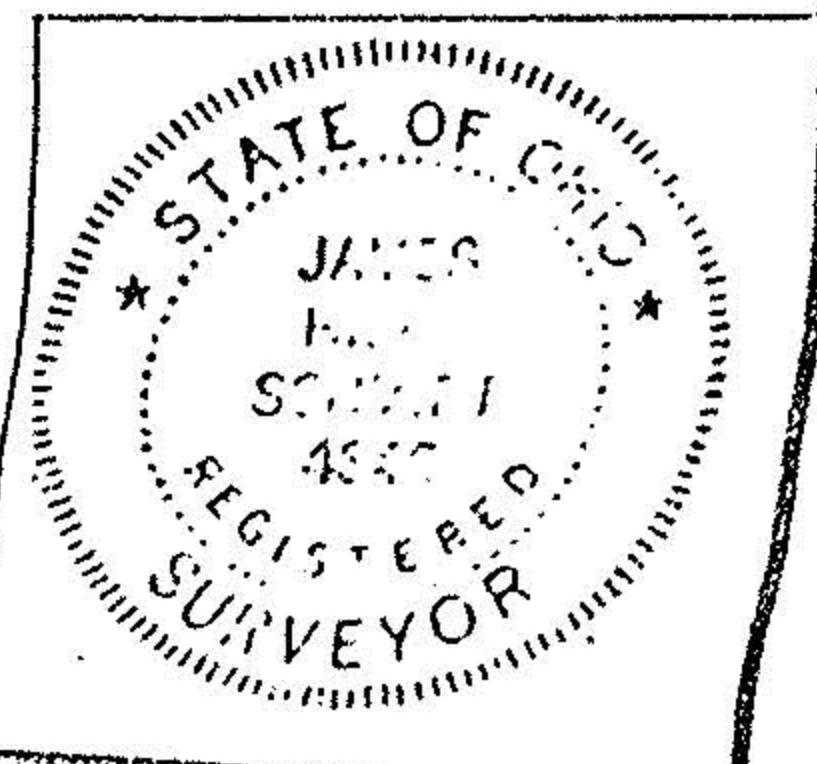

97-00-014-104

#18145

7-00-014-B