

9234

11-00-033-000  
- 004

11-00-033  
11-C

Survey  
Plat No. 127  
State of Ohio

Prepared by  
FORD & ASSOCIATES  
H. FORD, C.E., Ohio

58 Acres



NOV 19 1975

Vol. 103 EASEMENT  
1975-103

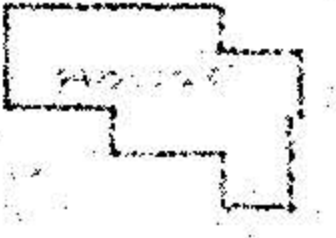

ROAD

ROAD

ROAD

Survey  
Plat No. 127  
State of Ohio

125.93	350.00 PCL D 1.0083 Ac. ①	125.93
100.00	PCL C 0.8035 Ac. ②	100.00
100.00	PCL B 0.8035 Ac. ③	100.00
110.00	PCL A 0.8838 Ac. ④	110.00
N 89 46 10' W 350.00		

20' EASEMENT

NOV 19 1975  
DEC 31 1975

Vol. 103 EASEMENT

No. 350 E  
1927-51 OBS

58 Acres

Prepared by  
FORD & ASSOCIATES  
H. FORD, C.E., Ohio

