

#11263

12G

12 06 32

12-00-032-000

MALLET CREEK - BAY VILLAGE ROAD 60' S.R. 252

N 0° 55' 50" E  
194.40  
200.00

Samuel M. & Phyllis Mabry  
Vol. 1066 Pg. 348

Francis J. & Mary Ann  
Kobie Vol. 1069 Pg. 177

James F. Jr. & Gayle Hoyt  
Vol. 1070 Pg. 884

Metro A. & Barbara V. Arden  
Vol. 1087 Pg. 663

N 88° 52' 09" E  
460.59'

12-00-032-000  
-032  
6.090 Ac.

N 0° 55' 50" E  
579.26'

320.94'  
S 1° 12' 46" W

N 87° 11' 35" E  
547.62'  
566.51'

18.89'  
55.00'  
290.44'  
N 89° 18' 43" W

379.39'  
S 30° 31' 37" W

Charles & Gertrude Hollan  
Vol. 1039 Pg. 51

O.L. 32  
O.L. 31

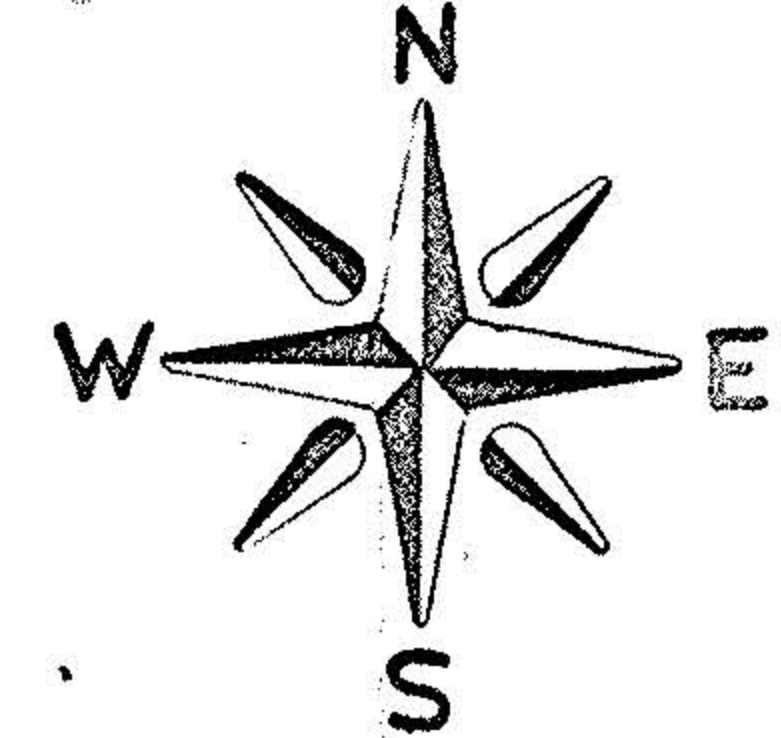

LEGEND

- I.P. Set
- I.P. Found
- ⊗ State Highway Monument

LOT NO: 32	Tr. or Sec.:
TOWNSHIP: COLUMBIA	
COUNTY: LORAIN	STATE: OHIO
OWNER: CHARLES HOLLAN	
DATE: NOV., 1977	SCALE: 1" = 200'

JOHN A. BAMBECK & ASSOCIATES, INC.  
991 MEDINA ROAD, MEDINA, OHIO, 44256  
Telephone: 216-239-1001

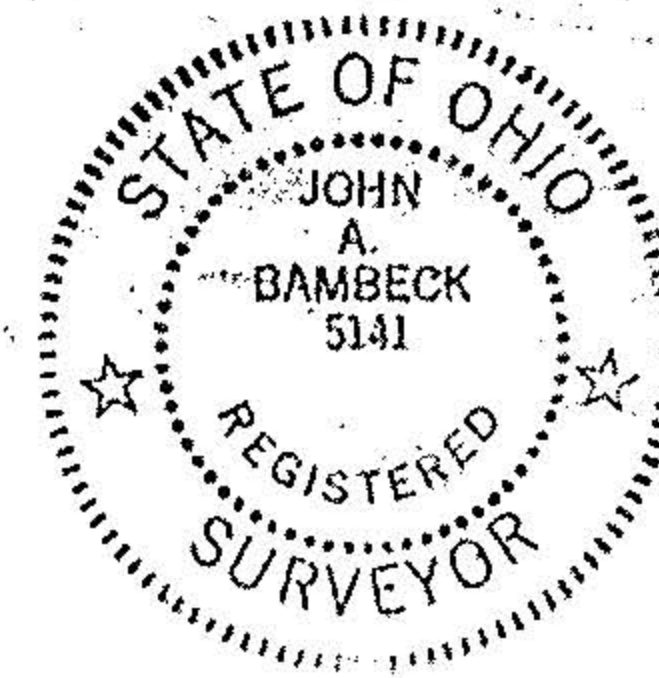

PROJECT NO. 77-541