

PARCEL No 1  
0.0460 Ac.  
C=1:71428.

RURAL LORAIN COUNTY  
WATER AUTHORITY  
V.1354 P.47

C=1:20000.  
PARCEL No 2  
9.6029 Ac.

C=1:1000000.  
PARCEL No 3  
1.2151 Ac.

C=1:INF  
PARCEL No 3  
12.7519 Ac.

RUSSIA TWP.  
CARLISLE TWP.

PARSONS ROAD 60'

CITY OF OBERLIN  
V.761 P.166

WEST BRANCH OF BLACK RIVER

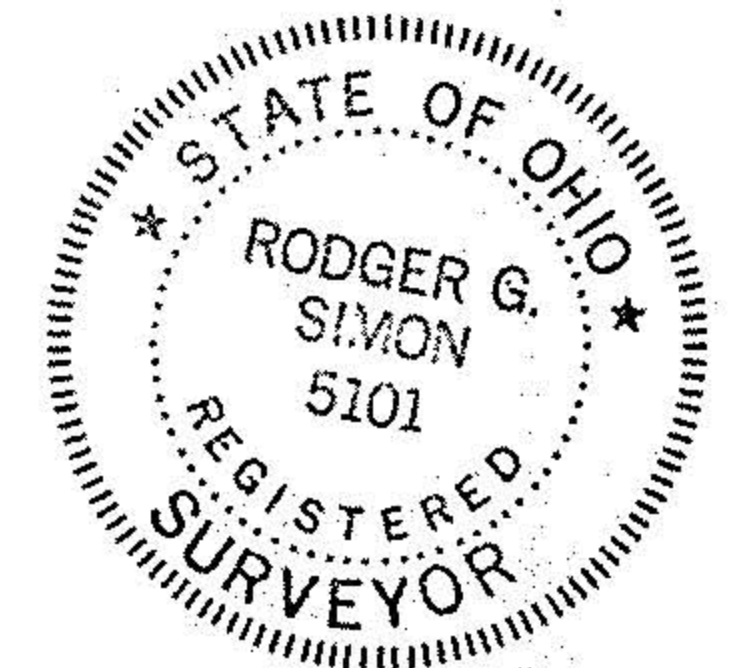
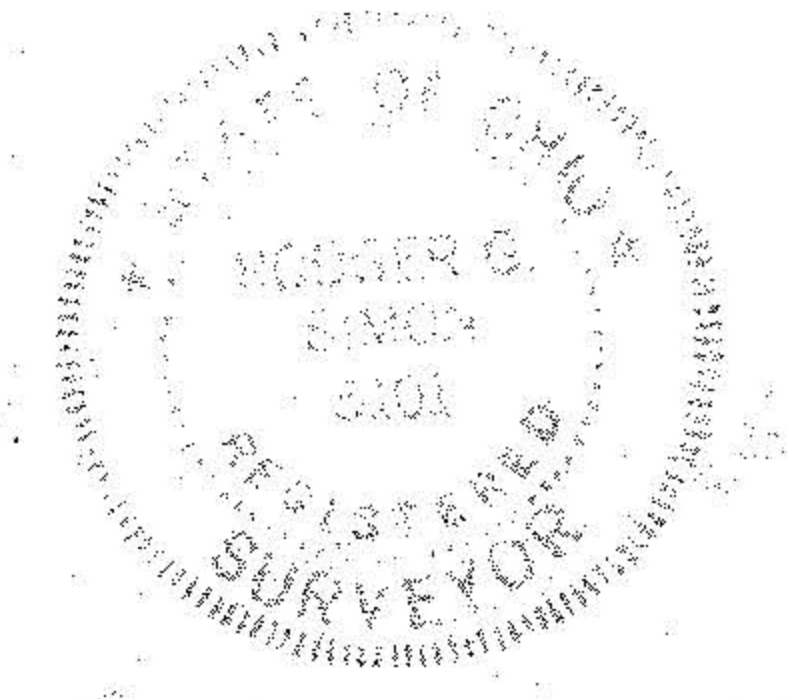
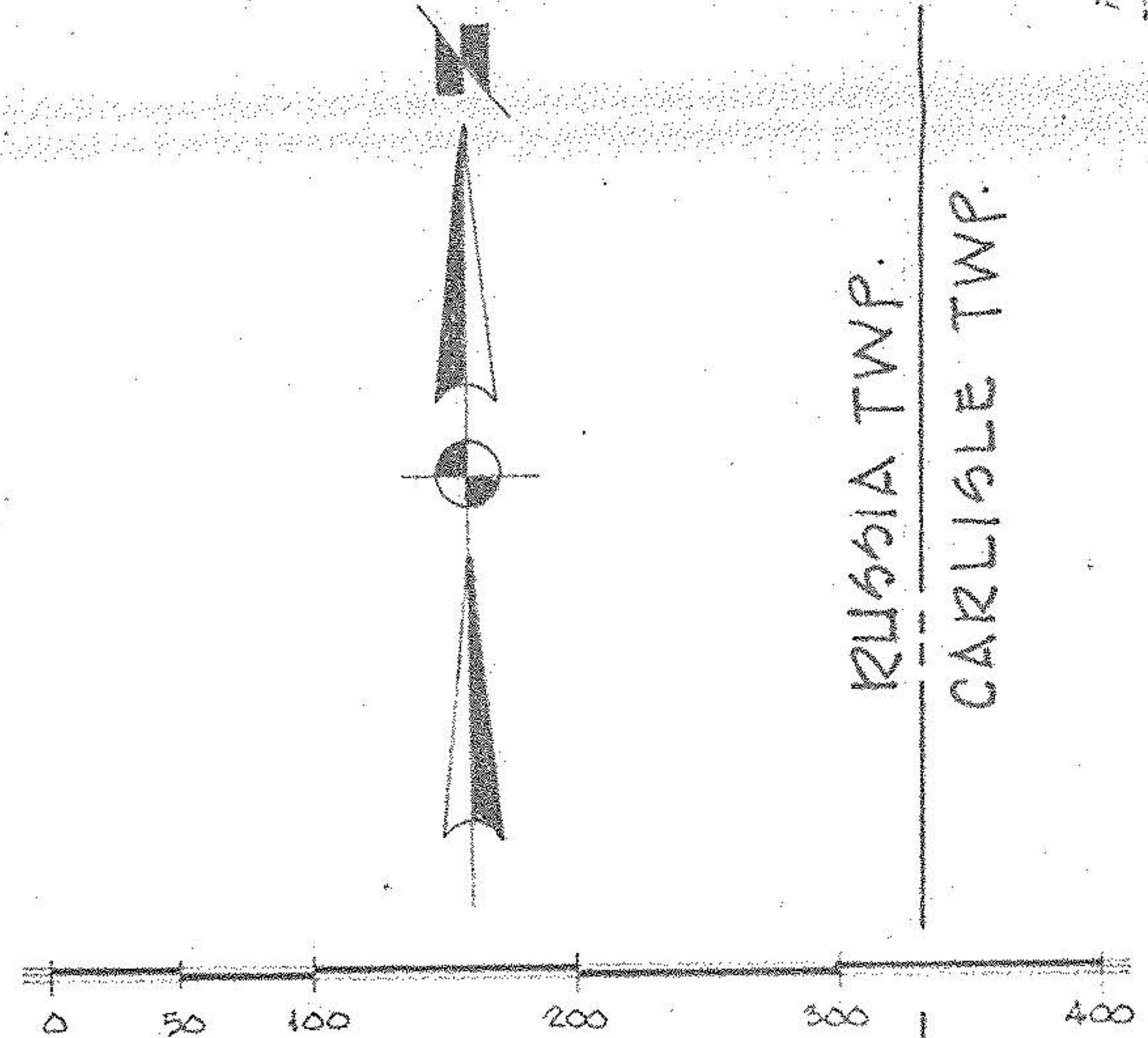

#18370  
APPROVED  
LORAIN CO.  
MAP DEPT.  
DATE 4-3-89  
PAGE 10 - E  
BY CAROL FRANCIS  
VOID AFTER # 18370

SURVEY FOR MAR 21  
DAN J. JR. & MARE CAMPBELL  
PART OF ORIG. SEC. 21 CARLISLE TWP.  
COUNTY OF LORAIN STATE OF OHIO  
SCALE 1"=100' MARCH, 1989  
LAUNDON • SIMON • CAHL & ASSOC.  
ENGINEERS 89-1799 SURVEYORS