

PROPERTY LINE & DAMAGE SURVEY
 FOR DIXIE A. HERLMAN
 SECTION NO. 12 - CARLISLE TWP.
 LORAIN COUNTY - OHIO

SCALE: 1"=40' JUNE 6-8, 1976
 Gary E. Penfound
 Reg. Surveyor No. 4457

20' EASEMENT
 File No. 9081921

NOTES: ○ indicates railroad spike found.
 ● indicates iron pin set.

10.00-012-000-117
 10.00-012-B



N. 15° 00' E.
 140.17'

0.7934 ACRE

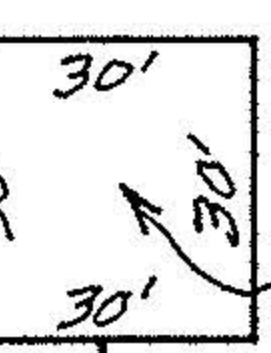

House Foundation Staked Aug. 8-1978

Dixie A. Herlman D. Vol. 1149 Pg. 854

5.75° 00' E.
 100.00'

Bulldozed Area

Water Line
 Top of Bank

111.96' 72.87' 130.77'
 395.60'

Bulldozed Area (to Top of Bank) 9540 Sq. Ft. (0.1042 Ac.)
 Easement Area " " " 1900 Sq. Ft. (0.0321 Ac.)
 Coinciding Area " " " 440 Sq. Ft. (0.0101 Ac.)
 Illegally Damaged " " " 4100 Sq. Ft. (0.0941 Ac.)

N. 75° 00' W.
 100.00' 225.00'
 BUTTERNUT RIDGE ROAD ST. RTE. 10
 1450.00'

Westerly Line D. Vol. 997 Pg. 329
 Robert A. & Shirley A. Saddle

60'