

HARRY E. & JEAN A. DAY
V. 1010 P. 718

400.00

I.P.Fd.

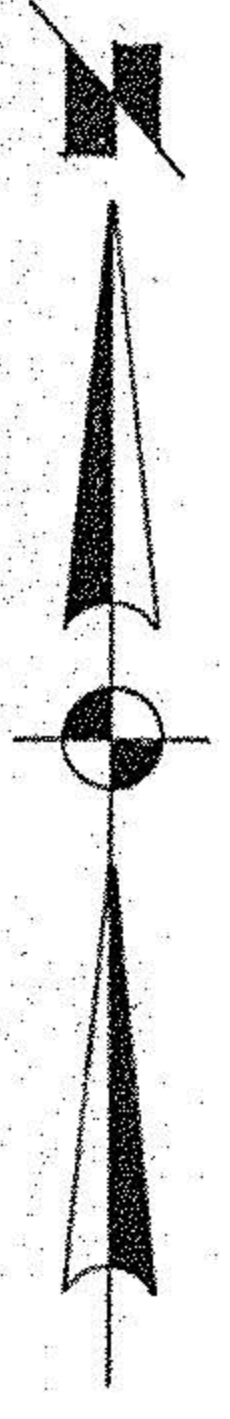

SURVEY FOR
FRANK H. & CAROL M. WESTON

PART OF O.L. 85
LORAIN COUNTY

EATON TOWNSHIP
OHIO

SCALE 1"=50'
LAUNDON • SIMON • CAHL & ASSOC.
ENGINEERS SURVEYORS
JOB NO 88-1752

DEC., 1988

FRANK H. & CAROL M. WESTON
RMOR. 6.89 AC.

OBERLIN COLLEGE
O.R.V. & P. 60 (Pl. 3)

1.P. 5et

EXISTING BUILDING

5.88°-03'-57"E. 755.10' ±

30.07'

I.P. 5et

N. 2°-11'-00" W.
272.67'

4.8391 Ac. ±

287.96'
S. 2°-00'-00" E.

DURKEE RD. 60'

11-00-085-000

#18299

APPROVED
LORAIN CO.
MAP DEPT.
DATE 1-23-89
PAGE 11-E
BY *Carol Francis*
VOID AFTER # 18299

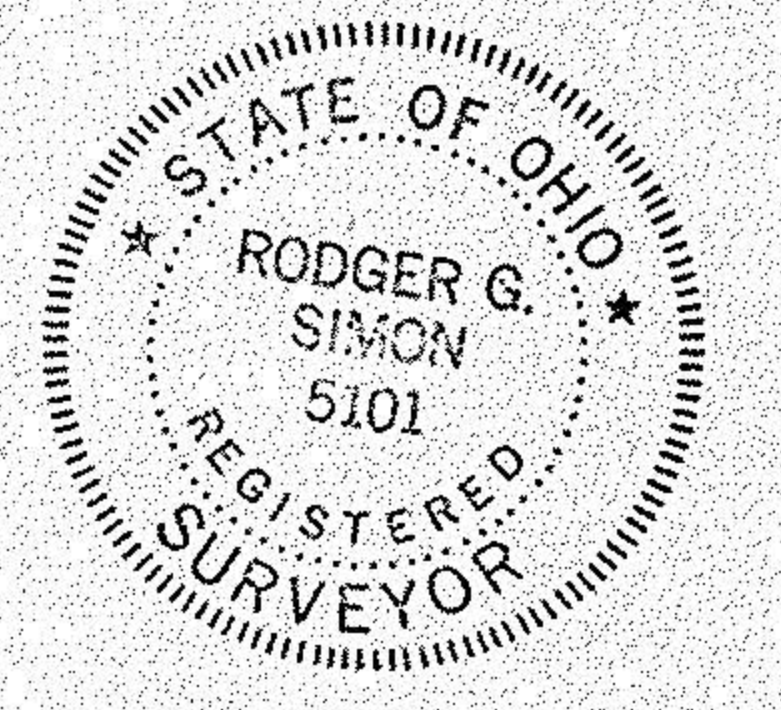

JAN 09

I.P.Fd.

N. 86°-57' W. 755.39' ±

OBERLIN COLLEGE
O.R.V. & P. 60 (Pl. 4)

I.P.Fd.

30.12'