

SCALE: 1" = 30'

S 3°55'10" W
DENHURST ROAD

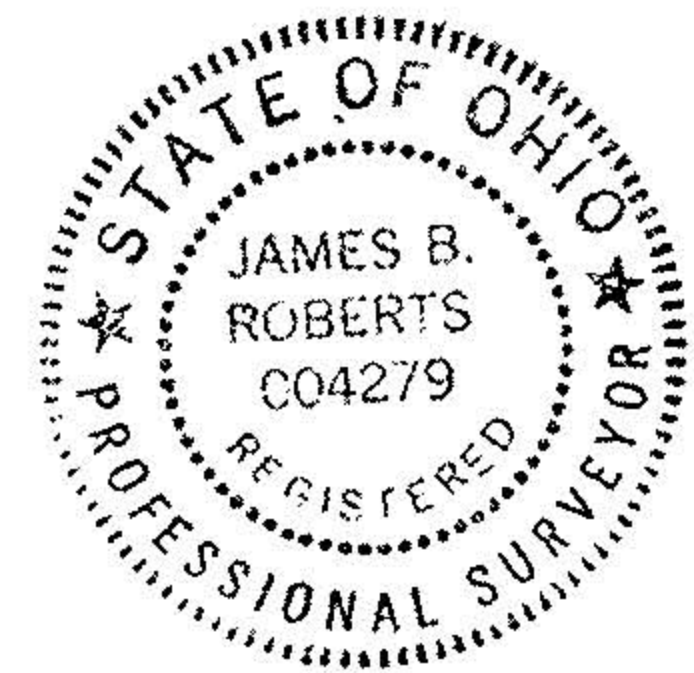

MAP of BOUNDARY SURVEY
PREPARED FOR THOMAS G. GREENROD
SUBLOT No. 20 in ROBIN PARK
SUBDIVISION No. 1

PLAT VOL. 34 PAGE 40
 PART of ORIG. CARLISLE TWP. SECTION No. 5
 NOW in CITY of ELYRIA , OHIO
 P.P. No 10-00-005-107-105

K. E. McCARTNEY & ASSOCIATES
 JUNE, 1992 #924030