

27 28 29 30 31 32

S-89°50'07"-E 465.01'

(246 AC±)

- 063
7.7069 AC.

11-00-081-102-058
CASCADE DEVELOPMENT CO., AN OHIO CORP.
O.R.V. 989 P. 931
10.2720 ACRES

(5.2695 AC±)

LARSON CONSOLIDATED, INC.
DV. 1134 P. 286

DURKEE ROAD 60'
(ELM STREET)

1253.99'
729.34'

230.00 P.
725.10'

671.14'

495.38 P.

S-0°07'00"-E

N-0°07'00"-W
524.65'

- 064
2.5651 AC.

S-89°50'07"-E
347.01'

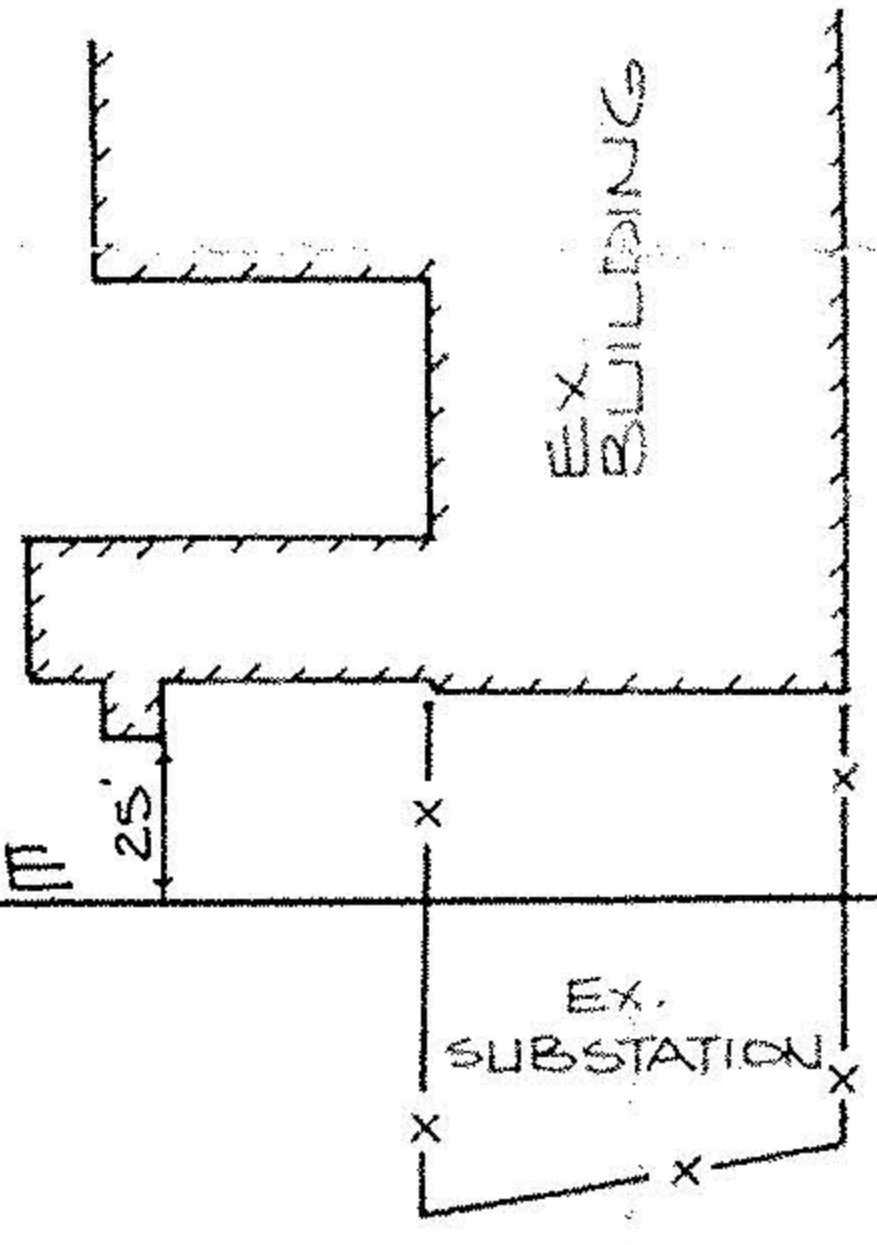

N-63°52'08"-E
131.30'
I.P. SET

333.38'
539.16'

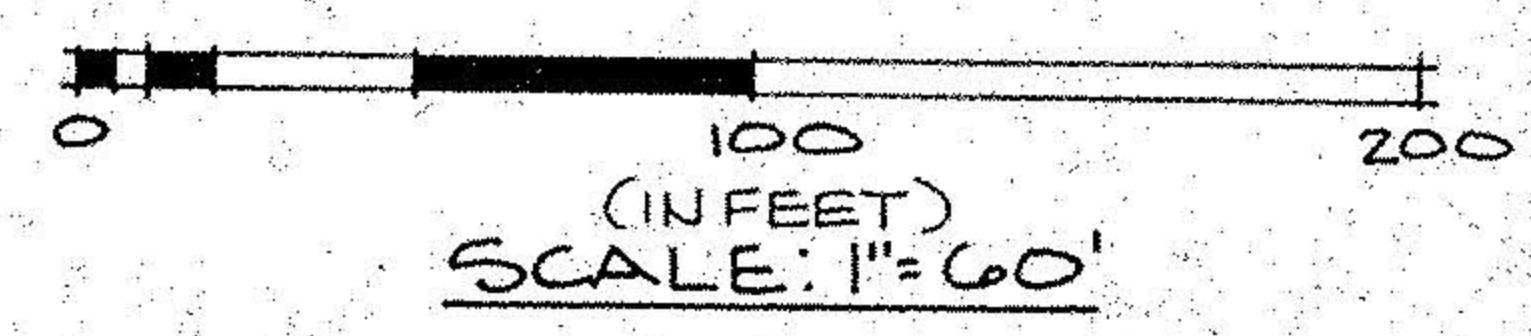

S-54°48'00"-W
250' R.

PATRICIA A. MACK
O.R.V. 181 P. 913
PCL. 2

200.00'
S-0°07'00"-E
PCL. 1

(NEW YORK CENTRAL RAILROAD)
CONRAIL
(FORMERLY C.C.C. & ST.L. RAILROAD)

21220

RECEIVED

APPROVED LORAIN CO. MAP DEPT
DATE 1-31-95
PAGE 11-00-081
BY CAROLYN FRANCS
21220

JAN 05 1995

CASCADE PATTERN

PRINTED

JAN 04 1995

KS ASSOCIATES, INC.

David L. Elwell
DAVID L. ELWELL
REG. SURV. NO. 6333

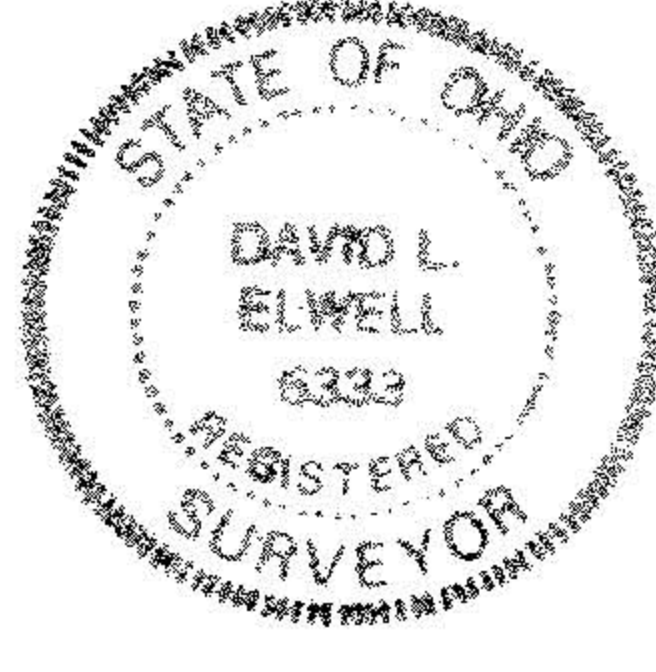

SURVEY MAP
PART OF ORIGINAL EATON TWP.
LOT No. 81
VILLAGE OF GRAFTON
COUNTY OF LORAIN STATE OF OHIO
NOVEMBER 18, 1994

PREPARED BY:
KS ASSOCIATES, INC.
ENGINEERS SURVEYORS
REV. 11-28-94
REV. 12-22-94
REV. 12-27-94
REV. 01-04-95