

A Glen W & Judith Nunn Div 1425 Pg 419

B Kathleen Ferry Div 1416 Pg 549

588°36'30"E & Copel Rd
675,00'

-032
6.664 Acres

-033

Reginia Reisinger
ETAL
OR 178 Pg 773
Remainder by Auditor
29.19 Acres

Thomas Scott
OR 156 Pg 29

N 88°43' W
225,00'
A
225,00'
588°43' E

N 88°43' W
225,00'
B
100,00' N

450,00'
N 88°36'30" W

Gerald A & Jean
Szcepanski OR 627
Pg 541

Ronald & Cherry L Combs

Durkee Rd
N 1°00' E

496,61'
S 1°00' W

Monument boxes
• iron pipes set
• iron pipes fd

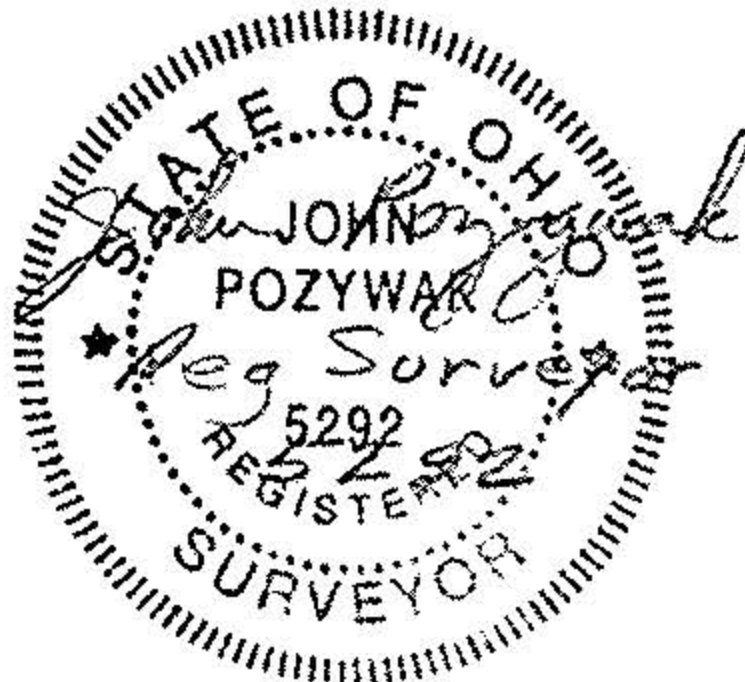

Survey of Parcel Split
for Tom Hahn
Original Lot 78
Eaton Township
Lorain County Ohio
Scale 1" = 200' Aug 1994

