

10-00-004-C

N 86°40'18" E
317.00'

N 86°40'18" E
38.26'

PARCEL NO. 3
0.8804 AC.

PARCEL NO. 2
0.0653 AC.

5 SL.

10-00-004-133-009

10-00-004-C

EAST RIVER ROAD
N 29°30' W
222.56'

PARCEL NO. 1
0.3344 AC.
-010
S 54°12'40" W 261.96'

Gor.

N 54°12'40" E
265.78'

○ I.P. Set
● I.P. Found

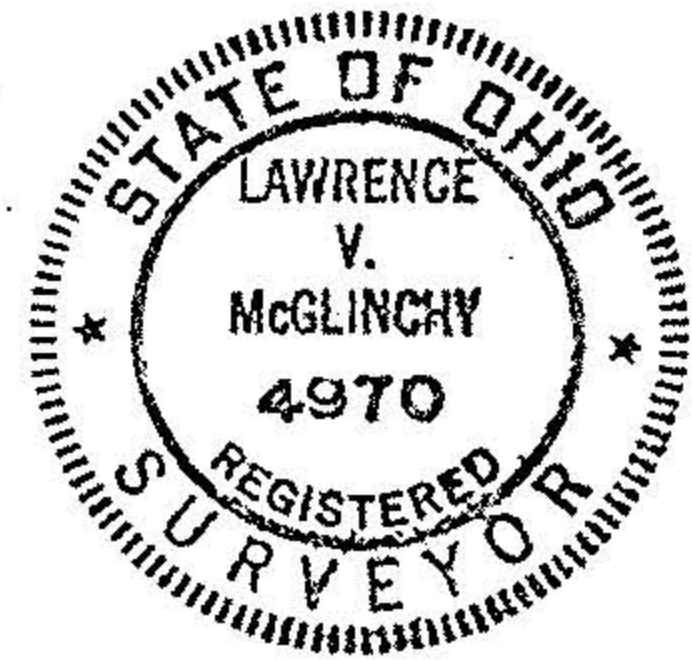

PLAT OF SURVEY FOR
DAVID R. STOKLEY
SECTION 4 CARLISLE TWP.
DIVISION OF SUBLOT NO. 5
CARL J. SMITH ADD'N LORAIN
VOL. 15, PG. 29 COUNTY

McGLINCHY & ASSOCIATES
PROFESSIONAL ENGINEER & SURVEYOR
538 W. BROAD ST, ELYRIA, OHIO
JOB No. 75357
JUNE 1975
REV. AUG.

AUG 28 1975

SEP 26 1975

1" = 40'

N 48°57' W

48.78'

8.57'

N 5°21'20" W
59.19'

N 35°47'20" W
55.00'

S 0°13' W
105.76'

110 -