

SCALE: 1" = 200'

LEGEND:
 ○ = IRON PIN SET
 ● = IRON PIN FOUND

20924

APPROVED
 LORAIN CO.
 MAP DEPT.
 DATE 7-7-94
 PAGE 9-00-100-A
 BY CAROLYN FRANCIS
 VOP # 20924

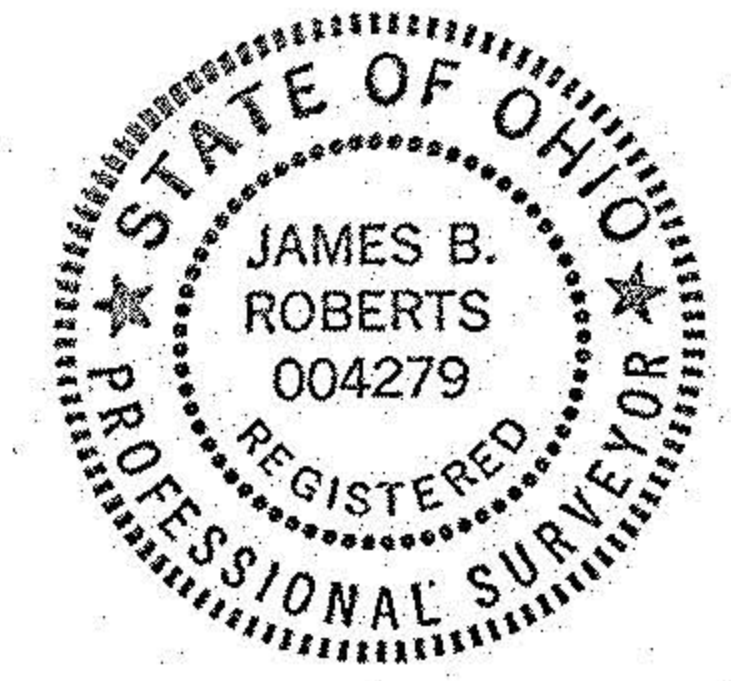

K.E. MCCARTNEY & ASSOCIATES
 ENGINEERS - SURVEYORS
 ELYRIA, OHIO
 FEBRUARY, 1994 #945075

MAP OF PROPOSED PARCEL SPLIT
 PREPARED FOR MICHAEL VISNIC
 PART OF ORIGINAL RUSSIA TWP. LOT Nos. 99 & 100
 TOWNSHIP OF RUSSIA, LORAIN COUNTY, OHIO
 REF: SPLIT FROM 09-00-099-000-071 & 09-00-100-000-005

09-00-100-000-005
 09-00-100-000-006
 09-00-100-000-007
 09-00-100-000-008
 09-00-100-000-009
 09-00-100-000-010
 09-00-100-000-011
 09-00-100-000-012
 09-00-100-000-013
 09-00-100-000-014
 09-00-100-000-015
 09-00-100-000-016
 09-00-100-000-017
 09-00-100-000-018
 09-00-100-000-019
 09-00-100-000-020
 09-00-100-000-021
 09-00-100-000-022
 09-00-100-000-023
 09-00-100-000-024
 09-00-100-000-025
 09-00-100-000-026
 09-00-100-000-027
 09-00-100-000-028
 09-00-100-000-029
 09-00-100-000-030
 09-00-100-000-031
 09-00-100-000-032
 09-00-100-000-033
 09-00-100-000-034
 09-00-100-000-035
 09-00-100-000-036
 09-00-100-000-037
 09-00-100-000-038
 09-00-100-000-039
 09-00-100-000-040
 09-00-100-000-041
 09-00-100-000-042
 09-00-100-000-043
 09-00-100-000-044
 09-00-100-000-045
 09-00-100-000-046
 09-00-100-000-047
 09-00-100-000-048
 09-00-100-000-049
 09-00-100-000-050