

#22265

APPROVED
LORAIN CO.
MAP DEPT

DATE 10/4/97

PAGE 8-E

BY K. Colbert

- ③ Melvin C Heidrich
Div 835 Pg 568
- ① Karen Heidrich
Div. 1259 Pg 511
- ② Julius & Donna Stayfa

Note: Ditch & courses

N 7°10'E 132.19'
 N 56°23'E 851.18'
 N 43°29'E 81.36
 N 18°58'E 84.05

Survey of Parcel Split
 Melvin Heidrich
 original Lot 3 Tract 13
 Henrietta Township
 Lorain County Ohio
 Scale 1"=400' Dec 1996 R

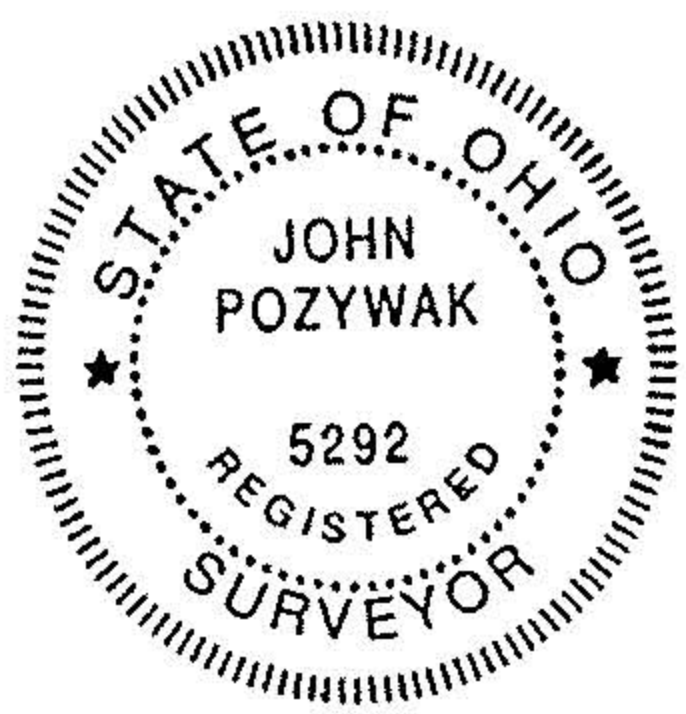

John Pozywak
 Reg Surveyor 5292