

**#18683**  
 APPROVED  
 LORAIN CO.  
 MAP DEPT.  
 DATE 10-19-89  
 PAGE 9-D  
 BY CAROLYN FRANKS  
 VOID AFTER # 18683

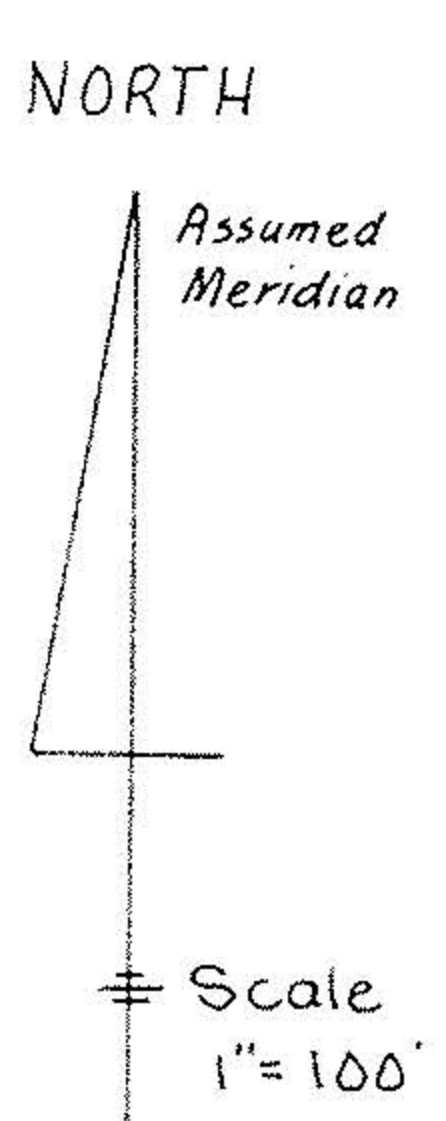

**LEGEND:**  
 Iron pin pipe found or set shown thus: -o-

E.C. = 10,000

*Charles P. Waryu*  
 CHARLES P. WARYU, Registered Surveyor No. 5029

MAP OF SURVEY OF LANDS, 1.1054 ACRES  
 PART OF O.L. 10, RUSSIA TOWNSHIP  
 LORAIN COUNTY, OHIO  
 Made at request of Wayne A. Baus  
 By Charles P. Waryu, Registered Surveyor No. 5029  
 September 1989