

Pt.-033
Pt.17.53 A.

Pt. 005

RD.

MARY AMMON VOL.314 PG.54 856.87
N-89°54'E

696.0

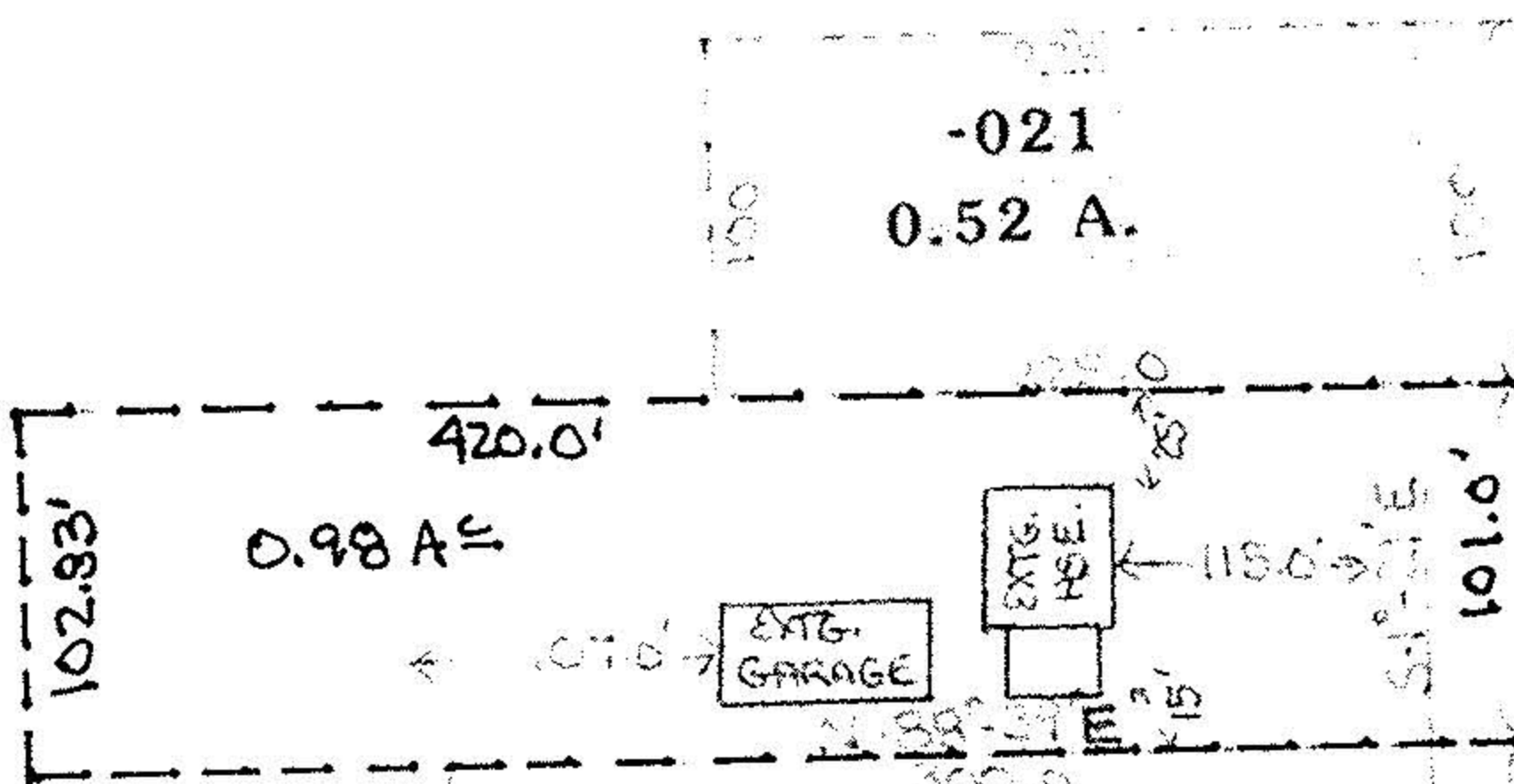

-021
0.52 A.

0.98 A.

Raymond E &
Charlotte Schwegel
VOL.669 PG.151

-010
2.07 A.

-024
13.77 A.
-0.98
12.79 A.

101

-026

-025

103

-023
6.57 A.

-023

-021

-011
0.75 A.

-019

-014
0.75 A.

-012
0.69 A.

-017

-013
12.98 A.

-007

REED

#19168

APPROVED
LORAIN CO.
MAP DEPT.

DATE 10-15-90

PAGE 7-00-012-C

BY CAROLYN
FRANKS

VOID AFTER # 19168

07-00-012-101-