

Pt.-033
Pt.17.53 A.

Pt. 005

RD.

MARY AMMON VOL.314 PG.54 886.84
N-88°34'E

696.0

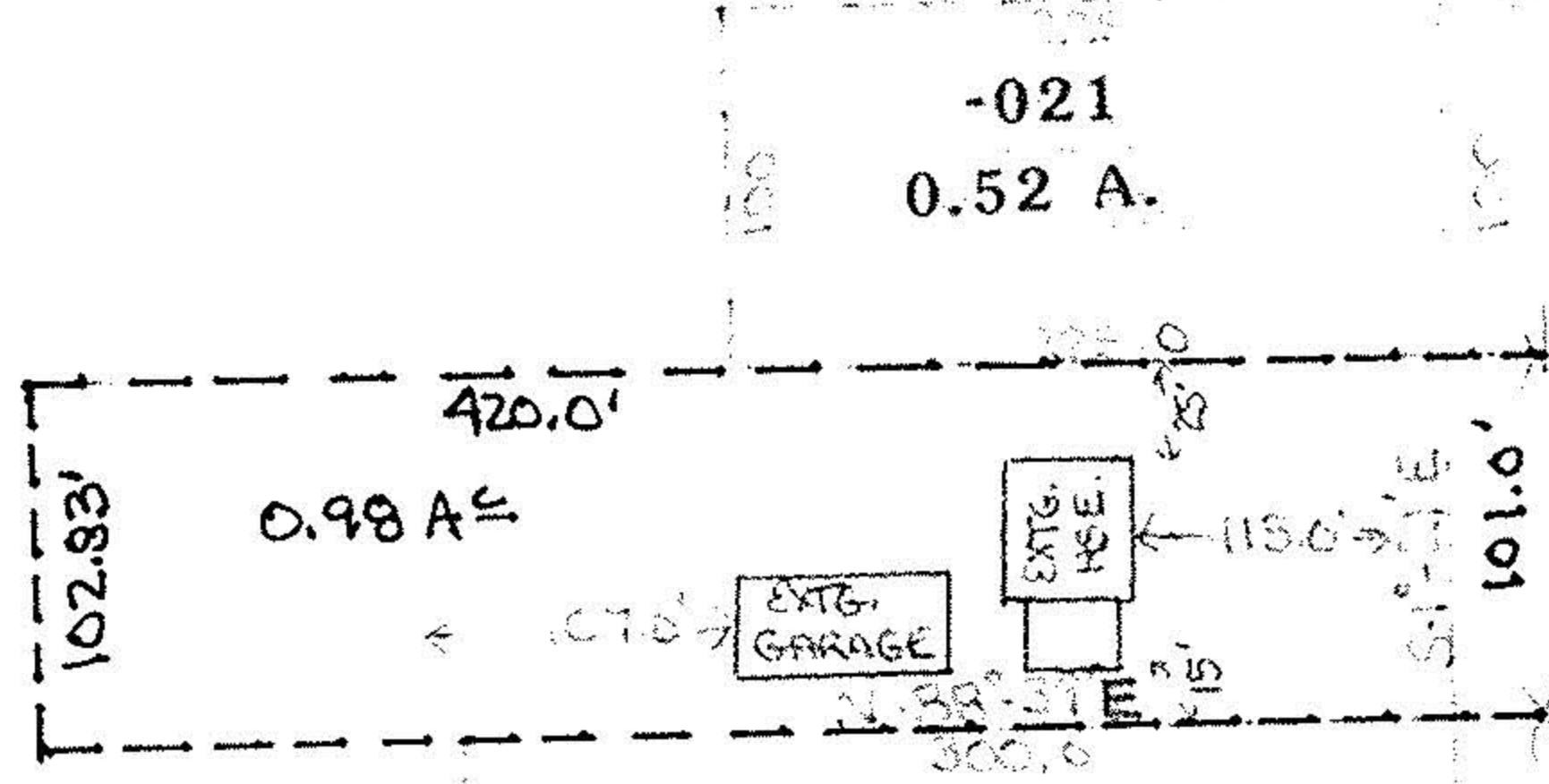

RAYMOND E &
CHARLOTTE Schwenke
VOL.669 PG.151

-010
2.07 A.

-024
13.77 A.
-0.98
12.79 AC

101

-026

-025

103

-023
6.57 A.

-023

-011
0.75 A.

-021

-014
0.75 A.

-019

-012
0.69 A.

-017

-013
12.98 A.

-007

REED

#19168

APPROVED
LORAIN CO.
MAP DEPT.

DATE 10-15-90

PAGE 7-00-012-C

BY CAROLYN
FRANCIS

VOID
AFTER # 19168

07-00-012-101-

SCALE: 1" = 100'