

RECEIVED
JUN 19 1986
ENGINEERING

Paul 7. 11.11

#16928

APPROVED
RAIN CO.
MAP DEPT.
DATE 8-7-86
PAGE 7-00-008-C
BY C. FRANCIS
VOID AFTER 16928

LOT 17 - 7.1 ACRES
LOT 8 - 9.1 ACRES
TOTAL - 16.220 ACRES
CEL = 0.47

COMMERCIAL - 5.58 AC
APARTMENTS - 10.64 AC
CEL - 0.47 AC
TOTAL - 16.69

COMMERCIAL - 5.58
60' ACCESS - 0.74
COMMERCIAL - 4.84

Paul 6 - 5.58

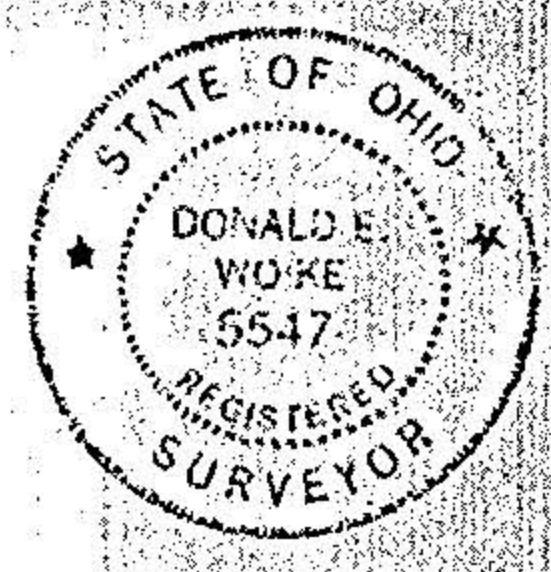

SURVEY
OF
16.690 ACRES ON CENTER RIDGE RD,
OF PARTS OF
ORIGINAL RIDGEVILLE TWP. LOTS 8 & 17
NOW IN
THE CITY OF NORTH RIDGEVILLE, OHIO
FOR
ERIE SHORES DEV. CO. INC.

BY
THE HENRY G. REITZ ENGINEERING CO.
BY Donald C. Woike VICE PRES.
SCALE 1"=100'
JUNE - 1973
REV. 5-1-77

CERTIFICATE
To all parties concerned with the title to the premises.
This is to certify that this survey drawing reflects a survey actually made on the ground per record description; that as of the date stated there were no encroachments either way across the property line, except as shown.
June 26th., 1973

Donald C. Woike
Reg. Surveyor No. 5547

EXHIBIT "B"

1061

