

- 035
 - 1.158 AC.

NOTE: NEIGHBOR'S FENCE
 ENCROACHES INTO
 THIS PARCEL AS SHOWN

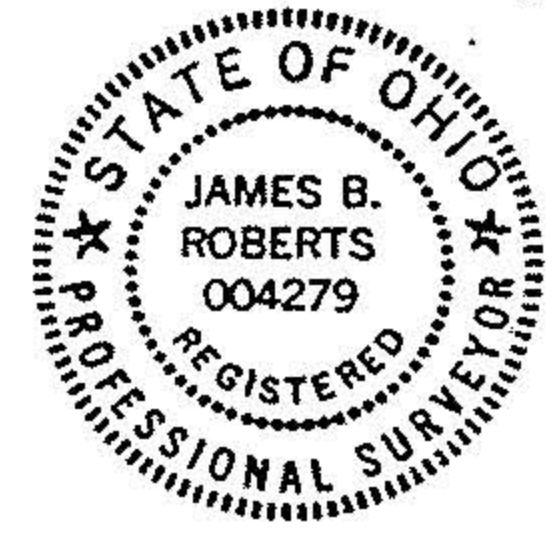
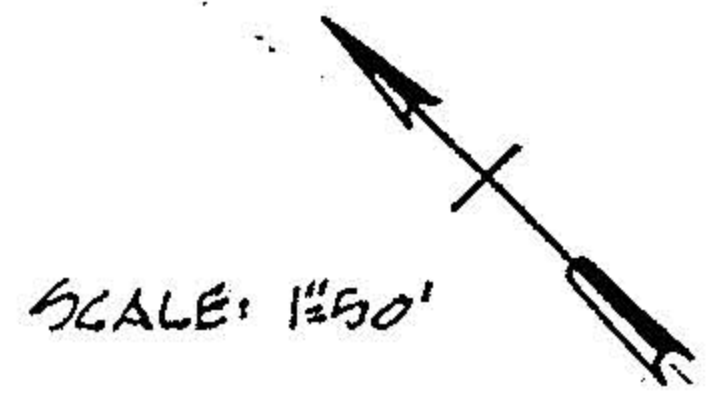

NOTE: "CROSS-HATCH" LINES DENOTE
 AREAS OF ORIGINAL PARCEL
 CONVEYED TO STATE OF OHIO.
 RE: DEED VOL. 1059, PGS. 286,
 288 & 290

○ = IRON PIN SET

MAP of PROPERTY SURVEY
PREPARED FOR: STURDY BUILT MFG. CO.
32100 LORAIN RD. NORTH RIDGEVILLE, OH.
PART OF ORIGINAL RIDGEVILLE TWP. LOT No. 4
CITY OF NORTH RIDGEVILLE, LORAIN COUNTY, OHIO

K.E. MCCARTNEY & ASSOCIATES
ENGINEERS & SURVEYORS
ELYRIA OHIO
MARCH, 1990 #903082