



KLEINOEDER-SCHMIDT

and ASSOCIATES

ENGINEERS — SURVEYORS — CONSULTANTS in LAND PLANNING

ELYRIA - NORWALK - MEDINA

OHIO

SURVEY

Sublot(s) _____

Subd'n _____

Township ELYRIA Tract EAST OF BLACK RIVER
 Orig. Lot(s) 7 Sec. _____
 County of LORAIN State of Ohio
 Corporation CITY OF ELYRIA

06-25-007-000-190

19657

DALE YOST
 d.b.a.
 D.B.L. CO.
 D.V. 1382
 P. 145

(-172)

2.05 AC.

19657

APPROVED	
LORAIN CO.	
MAP DEPT.	
DATE	11-14-91
PAGE	76-125
BY	CAROLYN FRANCIS
VOID AFTER	19657

0.911 AC.

(0.617 AC. REM.)

DALE YOST
 d.b.a.
 D.B.L. Co.
 D.V. 1382 P. 149

135.90'
 S-79°21'33"E

268.17'

R/W

57

OHIO ROUTE

E. BROAD ST.
 (SUGAR RIDGE RD.)

ABBE ROAD
 S-0°15'47"W 525.96'

EXISTING SHOPPING CENTER BUILDING

N-11°02'53"E 140.88'
 8" WALL

(0.294 ACRE)

-190

98.30'
 N-0°20'07"E

N-0°20'07"E
 (FORMER R/W)

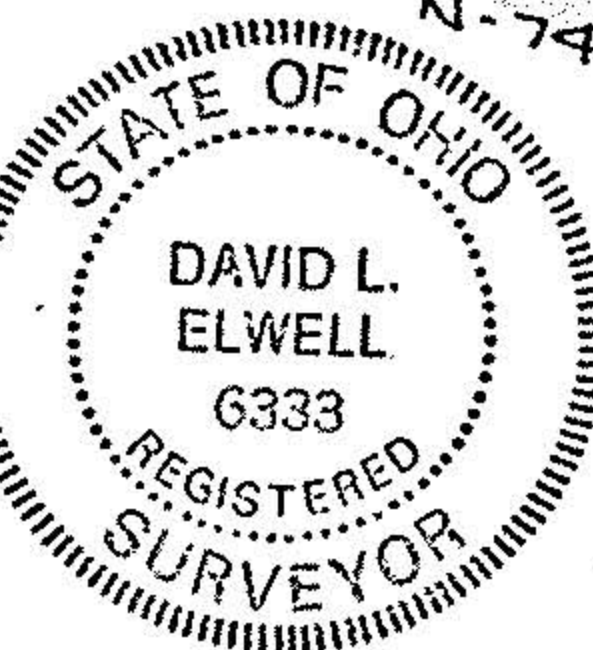

DOUG & NANCY GERBER
 (-179)
 O.R.V. 296 P. 95
 1.60 AC.

David L. Elwell REG. SURV. NO. 6333

Prepared for: DALE YOST
 REVISED 10-7-91 BY
 KS ASSOCIATES INC.
 ENGINEERS SURVEYORS

Scale: 1" = 30' Date: 1-17-86 Dr. by: D.E. Job No 81-110