

#8372

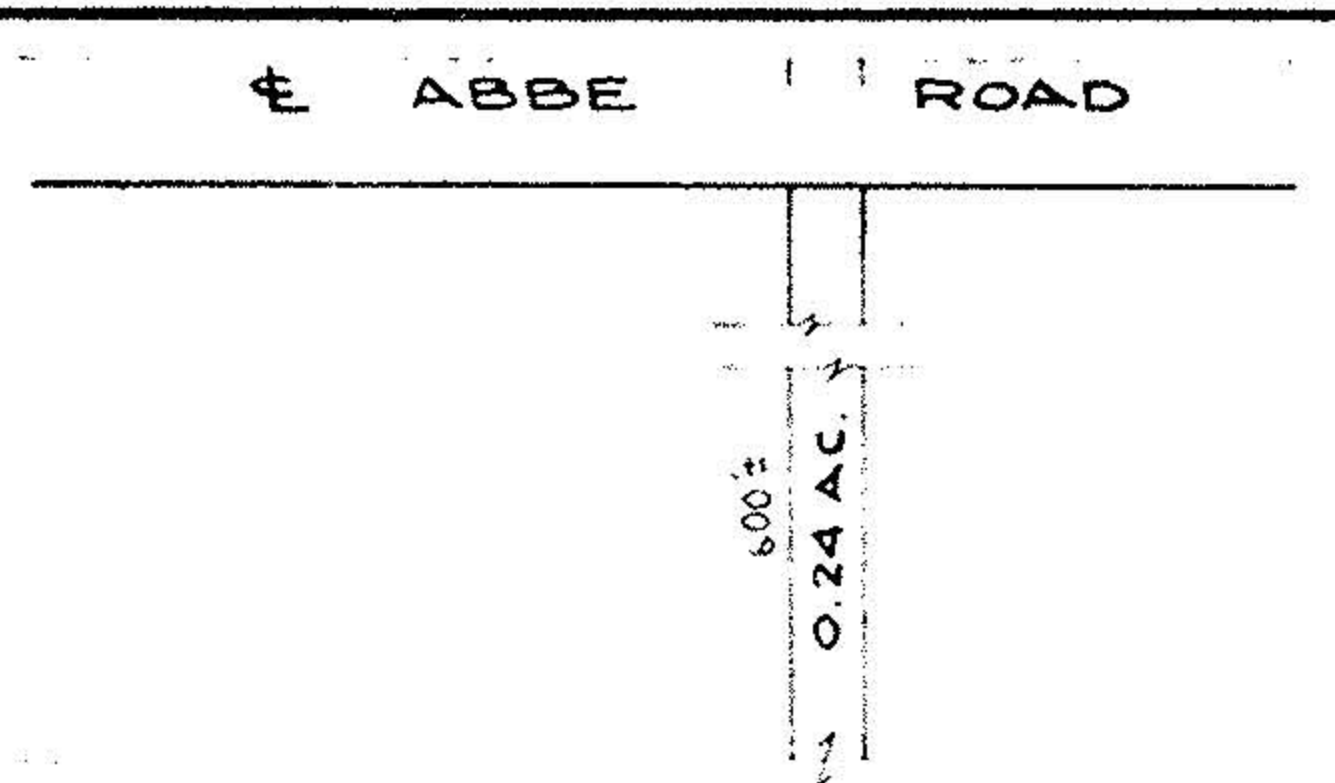

6-25-001  
6-25-007

6-144

ADAM & MARIE KRISTEK  
9.11 AC.

L.A. R/W

L.A. R/W

N-1°02'06"-E

6-144  
06-25-~~001~~-000

25.045 AC. O.L. 1

NOV 1 1974

DEC 1 1975

7.462 AC. ±

SPAETH  
M. P. 39  
D.V. 236  
CATHERINE

OHIO ROUTE BY-PASS  
EASEMENT TO STATE OF OHIO  
D.V. 803  
P. 540

6-144

4.448 AC.

06-25-007-000-019

RAYMOND H. SULLINGER & RICHARD R. SULLINGER

SOUTHEAST

ELYRIA TOWNSHIP ORIGINAL LOT NO 1  
RIDGEVILLE TOWNSHIP

ELYRIA TOWNSHIP ORIGINAL LOT NO 1  
ELYRIA TOWNSHIP ORIGINAL LOT NO 7