

00716

APPROVED LORAIN CO. MAP DEPT
DATE 4/10/01
PAGE 6-100
BY JHATFIELD
#01-00716

- LEGEND**
- 5/8" CAPPED REBAR SET
 - ⊙ IRON PIN/PIPE FOUND
 - Ⓜ MONUMENT BOX FOUND

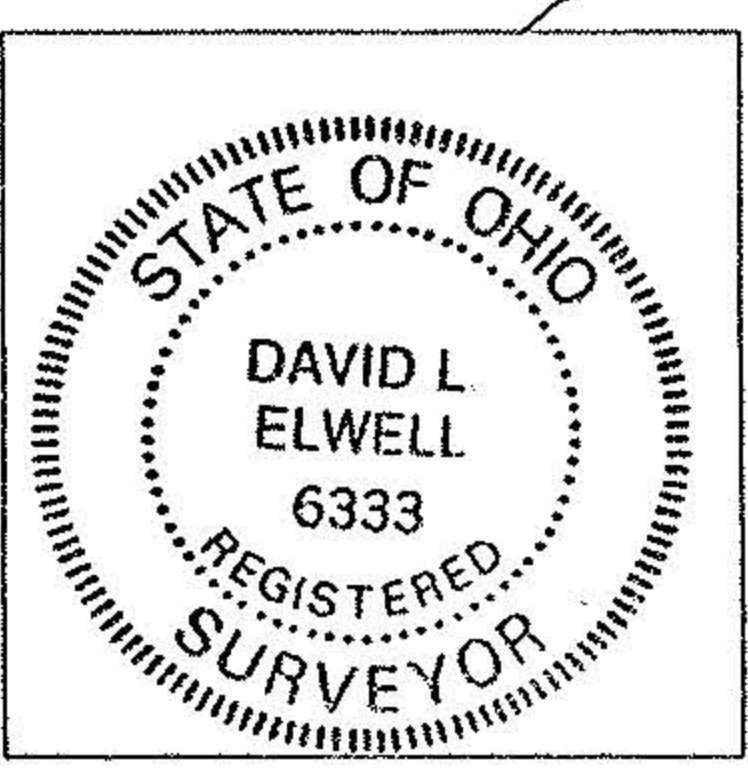

David L. Elwell
 DAVID L. ELWELL, REGISTERED SURVEYOR NO. 6333

KS ASSOCIATES
 424 Middle Avenue
 P.O. Box 569
 Elyria, Ohio 44036
 Phone (440) 322-6317
 Fax (440) 284-0623
 mallroom@ksassoc.com
 www.ksassoc.com

SURVEY MAP
 OF PART OF
 ORIGINAL ELYRIA TOWNSHIP LOT NO. 125
 WEST OF BLACK RIVER
 CITY OF ELYRIA COUNTY OF LORAIN STATE OF OHIO
 DATE: FEBRUARY 11, 2000 - REVISED: MARCH 2, 2000; MARCH 9, 2000

JOB NO. 991855
 DWG. NAME O-SURVOI