

06-24-036-112-025
- 026

#13909

1" = 20'

#13909

APPROVED
LORAIN CO.
MAP DEPT.
DATE 11-10-80
PAGE 6-61
BY Carolyn
VOID AFTER 13909

SUBLOT NO 1 of BLOCK 2 of
 THE GARDEN ACRES ALLOTMENT
 PLAT VOL. 9, PG. 27 PART of ORIG ELYRIA
 TWP LOT 36 WEST of BLACK RIVER
 P.P. #06-24-036-112-007

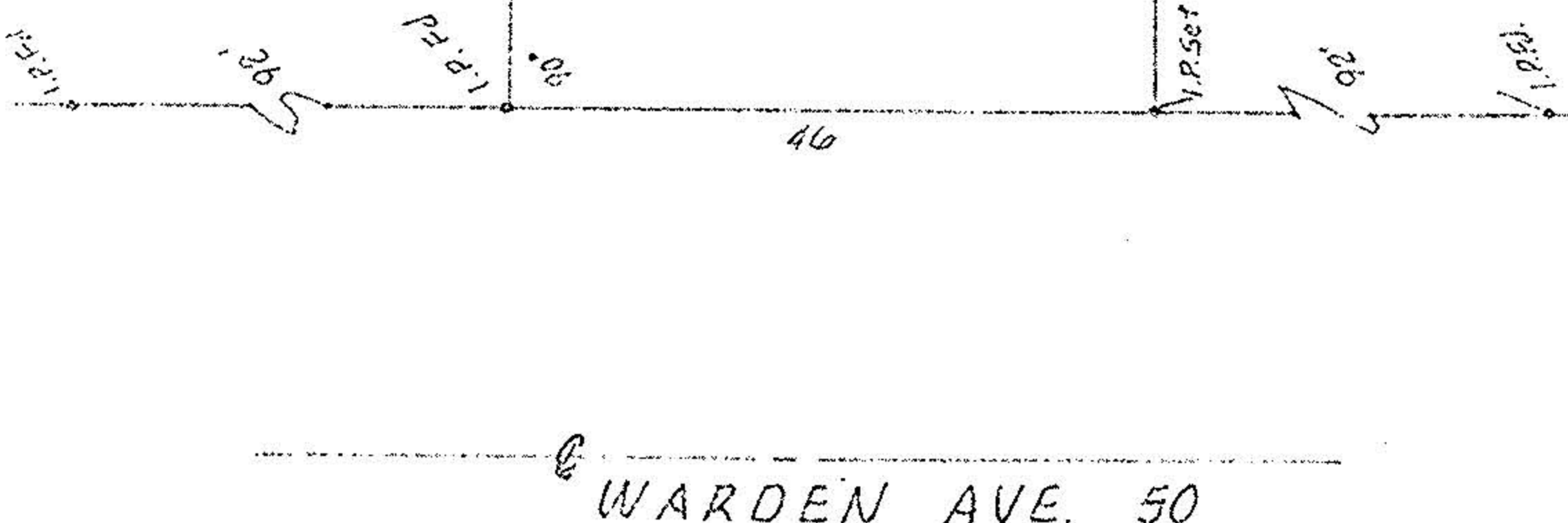

S.L.1
 S.L.2

CONC. BLOCK GARAGE

MAP of SURVEY for
 BILL GARRETT BUILDERS INC.
 674 OBERLIN RD. - ELYRIA, OHIO

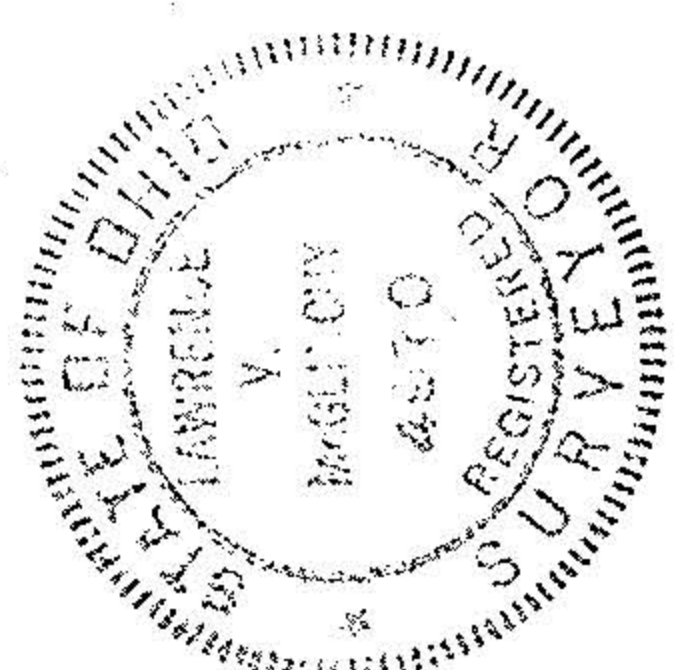

McGLINCHY & ASSOCIATES INC.
 REGISTERED SURVEYORS & ENGINEERS
 # 806224
 MARCH 5, 1980

TM-6-61