



LAUNDON • SIMON • CAHL & ASSOC. INC.
 CONSULTING ENGINEERS & SURVEYORS
 504 MIDDLE AVENUE ELYRIA, OHIO 44035

SURVEY FOR
 WILLIAM B. & ANDREA HUFFMAN

Orig. Lot	City of ELYRIA	Date 5-31-84 Scale 1"=40'
Orig. Sec	Village of	Dwn. by R.G.S. Chkd. by
Tract	County of LORAIN	Job No. 84-1290 F.B. 98 P. 38
Township of ELYRIA	State of OHIO	Printed

SURVEY of S/L 51 CASCADE COLONY P.V. 14 PGS. 12, 13 & 14

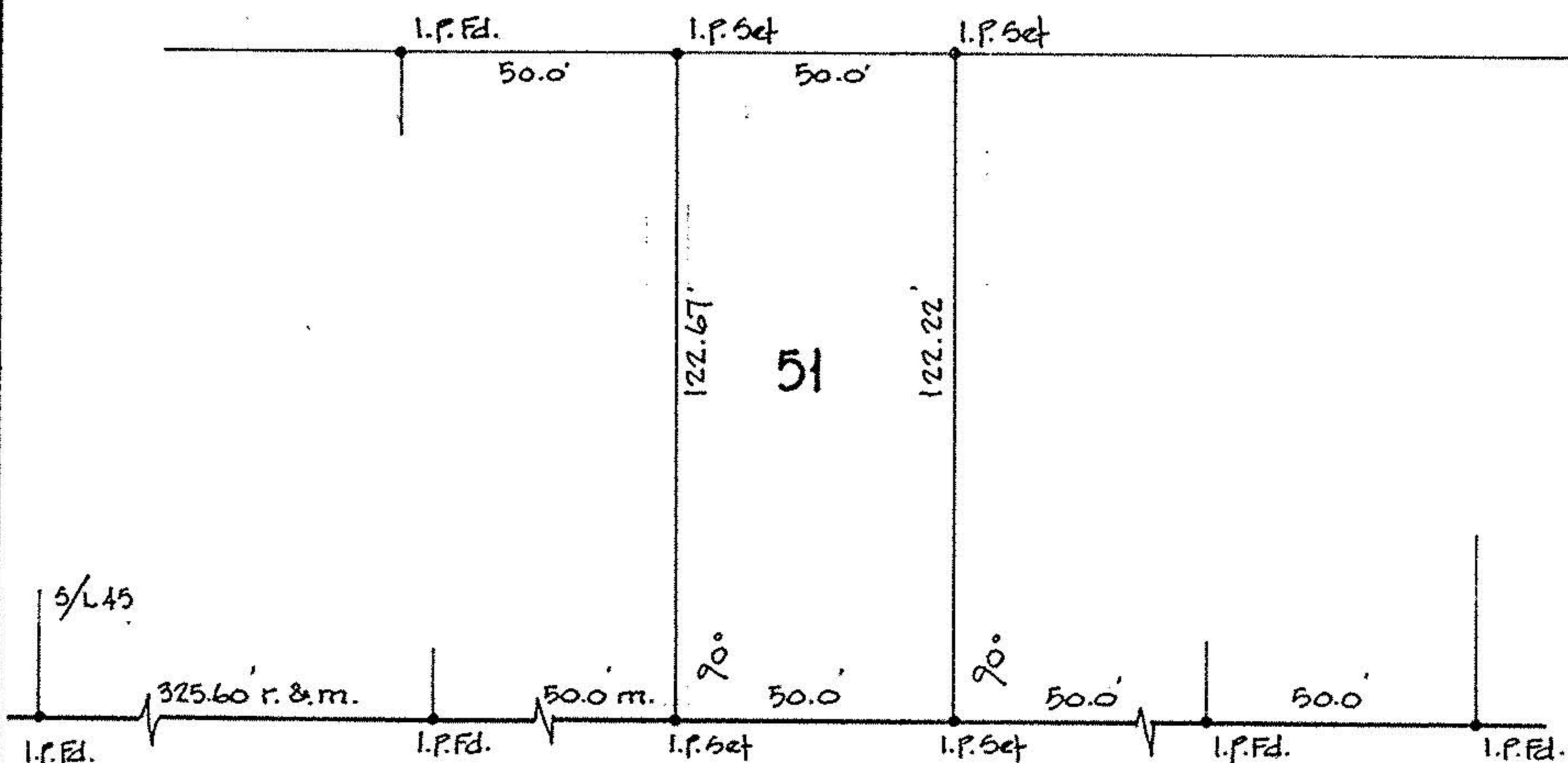

BELL AVE. 60'

