

JOHN EVANICH & MARY EVANICH
D.V. 432 P. 229

4.262 AC.

KENNETH A. & BETTY ANN GALL D.V. 1018 P. 866
PCL. 1 PCL. 2

CONNA SCHWIND WHITMORE
RICHARD G. SCHWIND
DAVID W. SCHWIND
D.V. 1045 P. 362

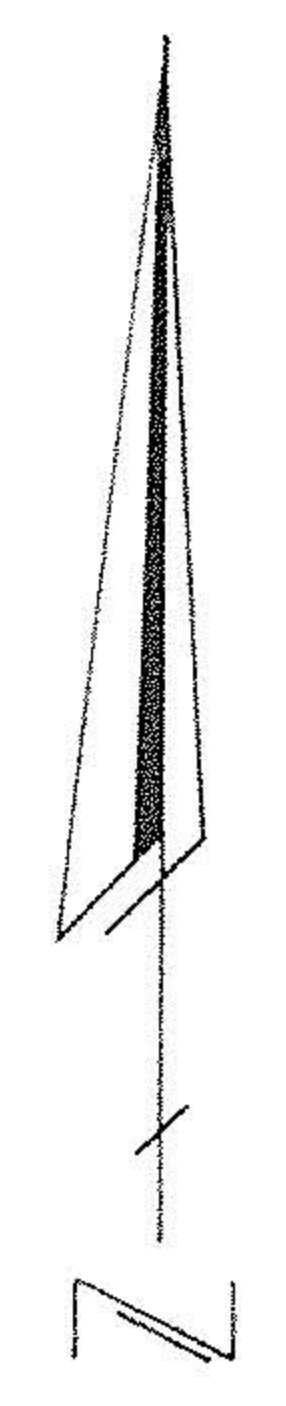
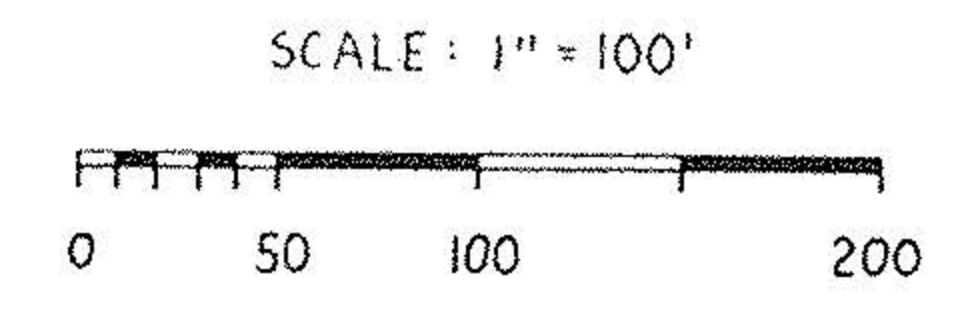

21 22

SURVEY MAP

OF PART OF
ELYRIA TOWNSHIP ORIGINAL LOT NO. 21
WEST OF THE BLACK RIVER
TOWNSHIP OF ELYRIA COUNTY OF LORAIN
STATE OF OHIO

#18841
APPROVED LORAIN CO. MAP DEPT.
DATE 2-14-90
PAGE G-75
BY CAROLYN FRANCIS
VOID AFTER # 18841

PREPARED BY:
KS ASSOCIATES INC.
ENGINEERS & SURVEYORS
1-05-90

David L. Elwell
DAVID L. ELWELL REG. SURV. NO. 6333

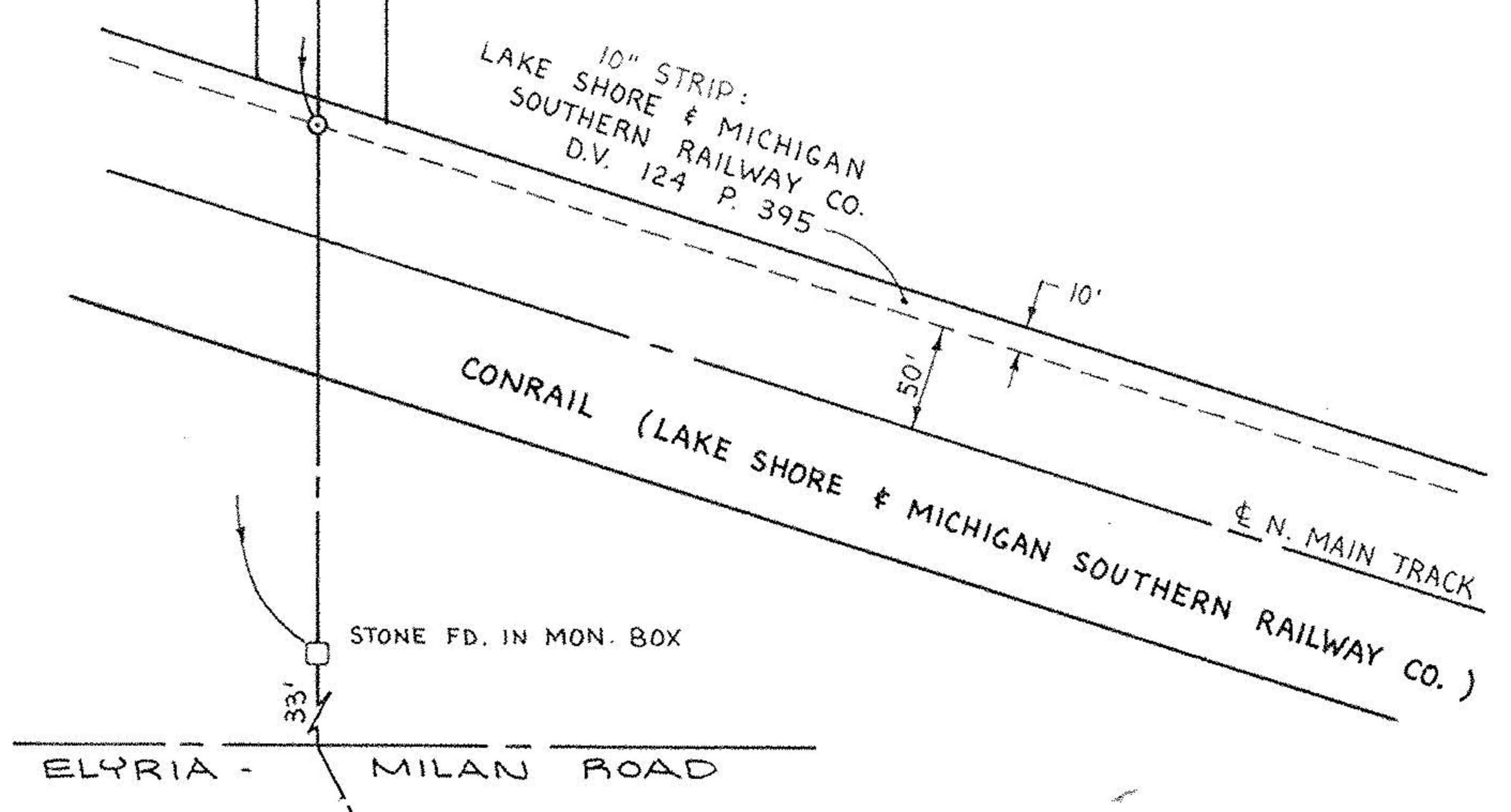
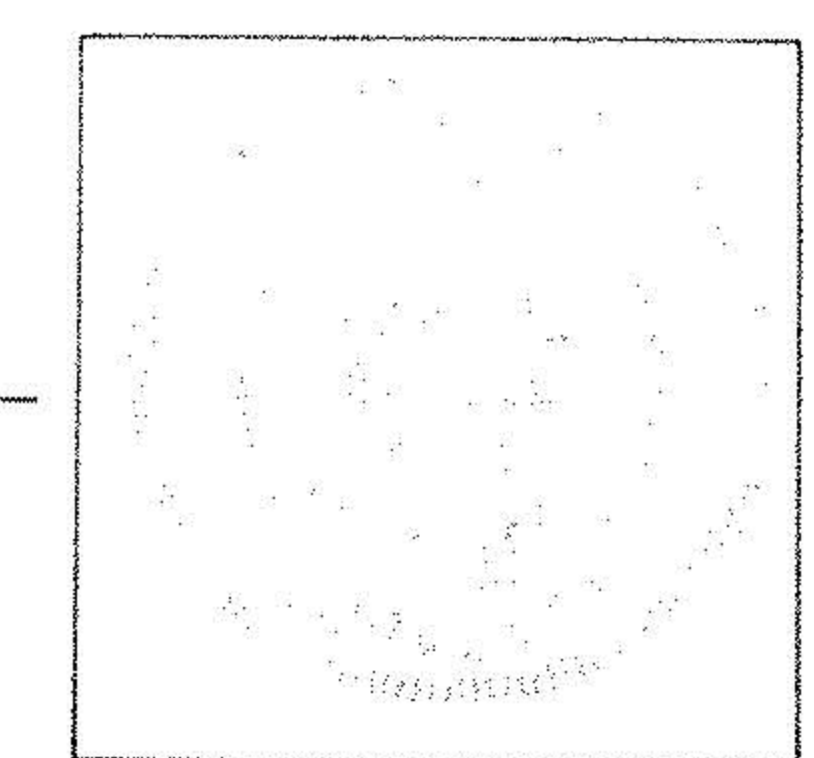

ELYRIA - MILAN ROAD