

NORTH 7289 WEST

N 89°-46' E 223.21' KEEP COURT 125.79 PLATS

30.01' 30.01' S 2°-12'-13" W

WESTERLY LINE OF CITY OF ELYRIA CORP. 16 AUGUST 1965 BY CITY RESOLUTION ORDINANCE NO 65-113 VOL 913 & 365 DEEDS.

N.E. CORNER O.L. #9

See ORD. 72-165

06-23-008-106

| | |
|----------------------|---------|
| 06-23-008-106-006-67 | 1437.74 |
| 008 1.68 | |
| 009 22 | |
| Total → 1.97 | |

PROPOSED 60' ROADWAY TO CITY OF ELYRIA 1.97 ACRES

30' 30' 6-26

N 89°-33' E 1437.74

S 89°-33' W 1419.86

6-25

MILAN STEEL INDUSTRIES

BRACE TRACT WEST OF BLACK RIVER
N.E. CORNER ORIGINAL LOT #9
S.E. CORNER " LOT #8
CITY OF ELYRIA
LORAIN COUNTY OHIO

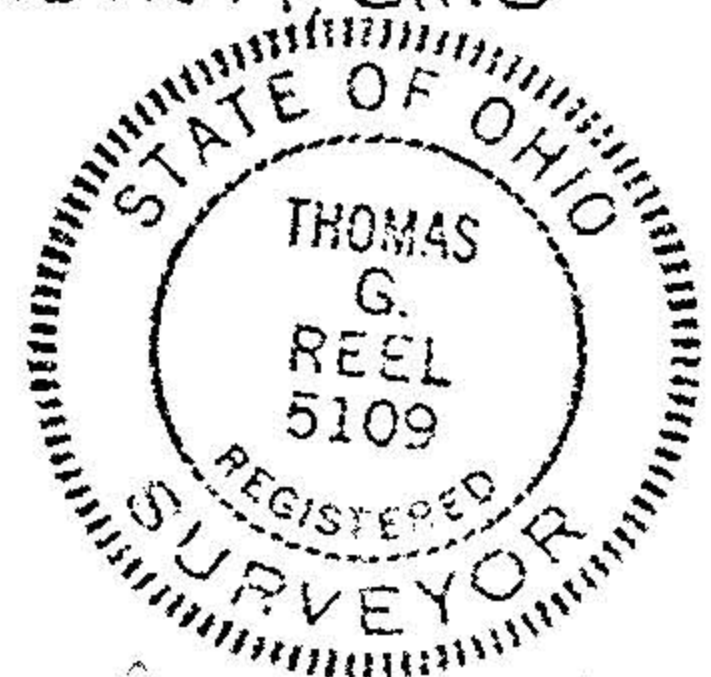

Thomas G. Reel
APRIL 1973
SCALE 1" = 200'-0"

FILE # 641 J

N 14°-31'-30" W 62.11'
BALTIMORE OHIO RAILROAD

6-25
6-26