

(NOTE: UTILITY INFO. TAKEN FROM CITY RECORDS ONLY. VERIFY BY TOPOGRAPHICAL SURVEY.)

60'

COURT

KEEP

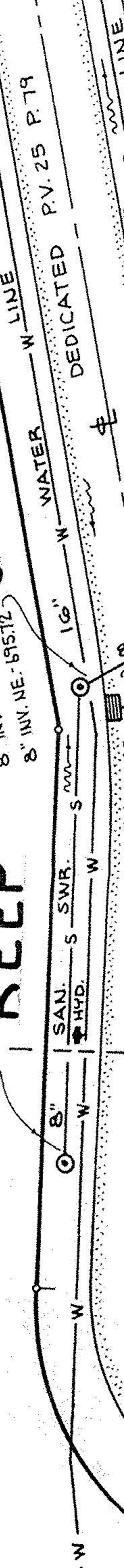

(-023) 1.23 AC. WALTER P. SLUSHER, TRUSTEE 12-12-78 D.V. 1223 P. 812

N-89°46'-E

689.81'

(-026) 7.48 AC.

101

GRAHAM "PCL. A-2"

(3.819 Ac.)

S-86°10'-W

361.53'

ROBERT

D.V. 1234

(1.417 Ac.)

8" INV. SW. 695.05
10" INV. N. 694.90

35.43'

S-10°14'-E

10.30'

S-1°46'-W

24" INV. 678.7±

58' R

58' R

191.91'

C.B. = S-32°53'59"E

Δ = 50°40'46" C = 12.76'

R = 85' A = 15.18'

A = 102.86'

N-86°10'-E

266.43'

S-86°10'-W

SUN LIFE ASSURANCE CO. OF CANADA

2-09-78

D.V. 1198 P. 25

(-021) 1.19 AC.

187.00'

N-3°50'-W

536.33'

S-2°12'-W

337.58'

CITY OF ELYRIA CORP. LINE

TOWNSHIP OF ELYRIA

2-14-80

D.V. 1255 P. 300

M. ADAM

JOSEPH

(-015) (2.60 AC.)



SCALE: 1" = 40'
JULY 22, 1981

13
ORIG. LOT LINE
14

PARCEL & UTILITY MAP

PART OF ORIGINAL LOT NO 13 IN THE BRACE TRACT OF ELYRIA TWP. NOW IN THE CITY OF ELYRIA, COUNTY OF

LORAIN, & STATE OF OHIO

PREPARED BY
KLEINOEDER-SCHMIDT & ASSOC.
CONSULTING ENGINEERS & SURV.

#14323

APPROVED
LORAIN CO.
MAP DEPT.
DATE 7-29-81
PAGE 6-26
BY <i>Carsteyn</i>
VOID AFTER