

TOTAL AREA = 21.47186 ACRES
 TAKE AREA = 21.47186 ACRES
 REMAINDER = 0.00000 ACRES

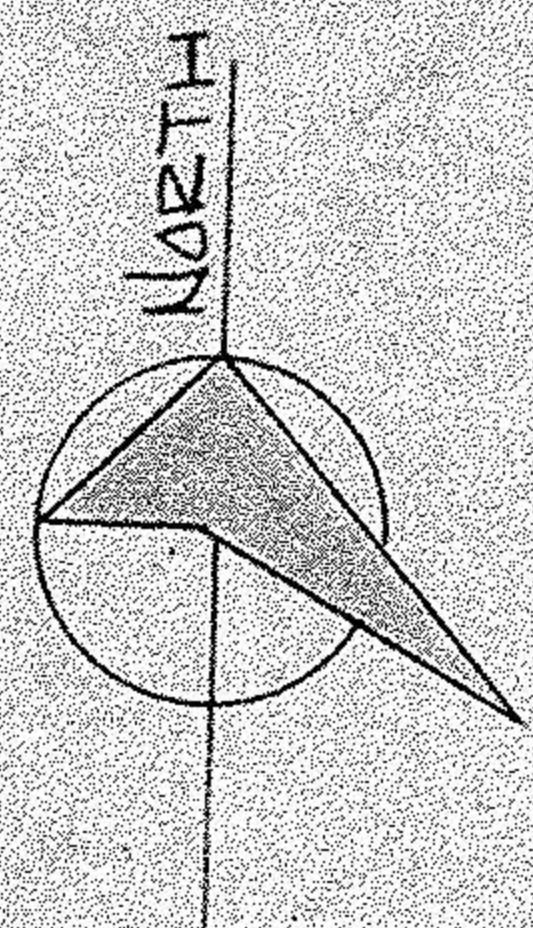

LORAIN COUNTY
 METROPOLITAN PARK DISTRICT

JACK JOSEPH
 VOL. 842 PGS. 660, 661

ΔL 20 BRACE TRACT S 88° 56' 45" E
 ΔL 21 BRACE TRACT

06-23-021-000-012

6-31

RIVER

LORAIN COUNTY
 METROPOLITAN PARK DISTRICT
 VOL. 952 PG. 683

AREA IN ΔL 20 = 0.18411 ACRES
 AREA IN ΔL 21 = 21.28775 ACRES
 TOTAL TAKE AREA = 21.47186 ACRES

JOHN TERRY - SPRING VALLEY ENT.
 VOL. 689 PG. 640, 641

BLACK

ΔL 21 BRACE TRACT
 ΔL 174 WEST OF RIVER
 909.03' M
 974.03' OBS. N 88° 33' 22" W

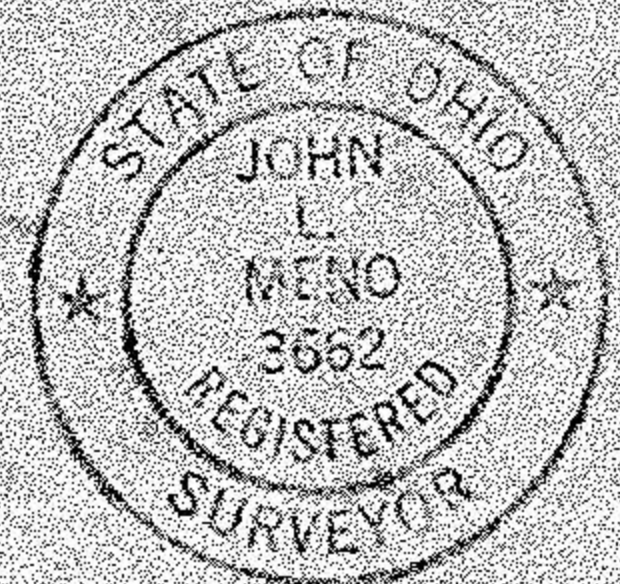

LORAIN COUNTY METROPOLITAN PARKS
 LAND ACQUISITION SURVEY
 JOHN TERRY - SPRING VALLEY
 ELYRIA TOWNSHIP

SCHAFFER, HURA & ASSOCIATES, INC.
 ENGINEERS AND SURVEYORS
 4370 OBERLIN AVE.
 LORAIN, OHIO



ORIGINAL LOT 20 & 21 BRACE DATE 1-30-
 TOWNSHIP ELYRIA SCALE 1" = 100'
 CITY OF FIELD BOOK 219 PGS 100-105
 COUNTY OF LORAIN DRAWN BY JFR
 STATE OF OHIO CHECKED BY J.L.M.
 W. O. 1685-37 FILE NO. 6-BRACE-20,21